

**EASIER TO SAFELY
LOAD AND
UNLOAD**



2019



COMPANY PROFILE

DAHLEN GROUP is established in 2001 as the German brand and become partner with Turkish Investors Company DÜELSAN in 2017. At the beginning DAHLEN is based in Germany, production and company is present in Turkey. Now company owned by the DÜELSAN GROUP.

DÜELSAN GROUP is a 100% Turkish family run company for three generations, established in 1976 in Samsun, Turkey. Pioneer and leader in the specialized area of hydraulic mechanical solutions for transportation of cargo and people, defense industry, work machines and for automotive sector starters, alternators electromechanical products and spare parts. Over the years the product portfolio has been steadily expanded with products such as the Tail Lifts, and the Access Platforms with DAHLEN brand name.

DAHLEN EUROPA LIFTS has a flexible production structure in an area covering 6.000 square meters. A worldwide service network including the supply of spare parts ensures fast and professional onsite support. For more than 43 years we have focused on customized solutions, design excellence, product development and sourcing.

DAHLEN EUROPA LIFTS, using its own technology, develops plans and manufactures equipment for the transportation of cargo and people, either attached to vehicles, or stationary, with a great emphasis on the use of hydraulic mechanical procedures.

Türkiye
Discover
the potential

Best Regards
DAHLEN EUROPA



2019
PRODUCT CATALOGUE
DAHLEN EUROPA



DHL.PV.9000

500 - 750 KG

Produced for panelvan vehicles with 500-750 KG capacity.

It has 2 different control system.

System works with two arms and it's mounted inside to the vehicle.

This model does not need to project, can mounted easily, safety and practice.

Lift Type
For Vans Mounted Inside

Lift Capacity
500-750 kg

Power Source
Battery of Vehicle 12-volt or 24-volt DC

Power Unit
Hydraulic Powerpack

Chassis Profile
80 x 80

Platform Type
Aluminum

Platform Size
Depends On The Vehicle

Paint Type
Oven Static Paint

Lift Arm Length	990 mm
Max. Lifting	750 - 850m
Max. Lowering	700 mm
Chassis Width	335 mm
Chassis Length	1.500 mm
Body Weight	130 kg
Platform Weight	Depends On The Vehicle
Cylinder	2 Lift Cylinder
Check Valve	1
Platform Size	1200x 1.500 mm
Fitting Bracket Max. Space	750 - 860 mm

TECHNICAL SPECIFICATIONS
Lifting Capacity: 500 - 750 kg
Working Pressure: 160 Bar
Loading Center: 600 mm
Lifting Speed: 0,1 m/s
Lowering Speed: 0,1 m/s
Opening-Closing Time: 7-8s
Platform Working Angle: 0 to +90°
Power Source: 12-volt / 24-volt DC
Platform Type: Aluminum
2 Unit Cylinder
1 Unit Check Valve
Hydraulic Powerpack
Hand Control Unit
Second Reserve Control Unit

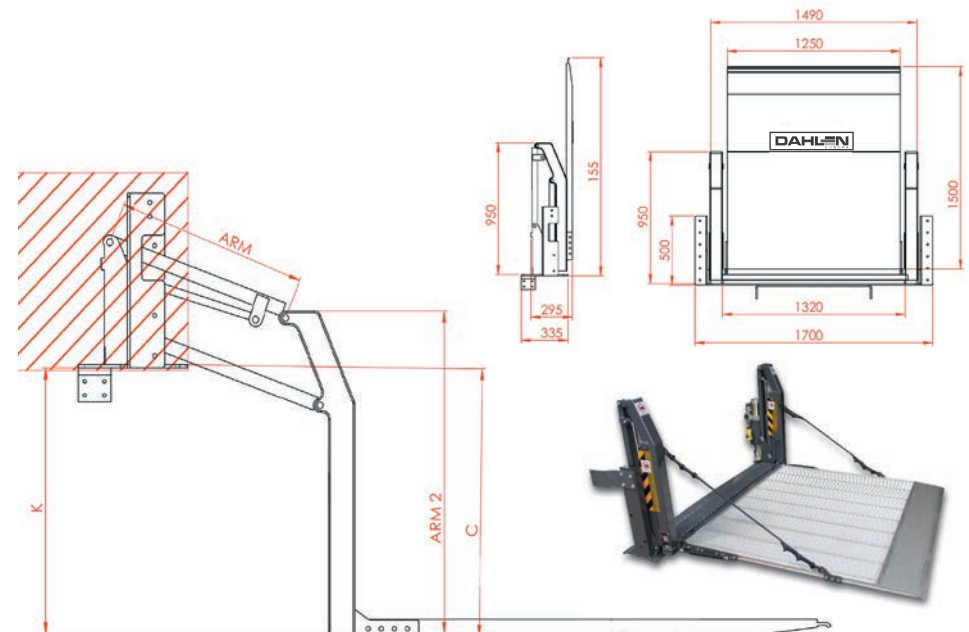



DHL.PV.9001

500 - 750 KG

Produced for panelvan vehicles with 500-750 KG capacity.

It has 2 different control system.

Tilt movement works manually.

Lift Type

Panelvan type, mounted outside (Small Arm)

Lift Capacity

500-750 kg

Power Source

Battery of Vehicle 12-volt or 24-volt DC

Power Unit

Hydraulic Powerpack

Chassis Profile

C Fitting Bracket 120 x 120 8 mm ST52

Platform Type

Aluminum

Platform Size

Depends On The Vehicle

Paint Type

Oven Static Paint

Lift Arm Length	700 mm
Max. Lifting	800 mm
Max. Lowering	350 mm
Chassis Width	300 mm
Chassis Length	1.100 mm
Body Weight	Depends On The Vehicle
Platform Weight	Depends On The Vehicle
Cylinder	2 Lift Cylinder +1 Tilt Cylinder
Check Valve	3
Platform Size	According to the Vehicle
Fitting Bracket Max. Space	830 mm

TECHNICAL SPECIFICATIONS

Lifting Capacity: 500-750 kg
 Working Pressure 160 Bar
 Loading Center: 600 mm
 Lifting Speed: 0,1 m/s
 Lowering Speed: 0,1 m/s
 Opening-Closing Time: 7-8s
 Platform Working Angle: +90°
 Power Source: 12-volt / 24-volt DC
 Platform Type: Aluminum
 3 Unit Cylinder
 3 Unit Check Valve
 Hydraulic Powerpack
 Hand Control Unit
 Second Reserve Control Unit

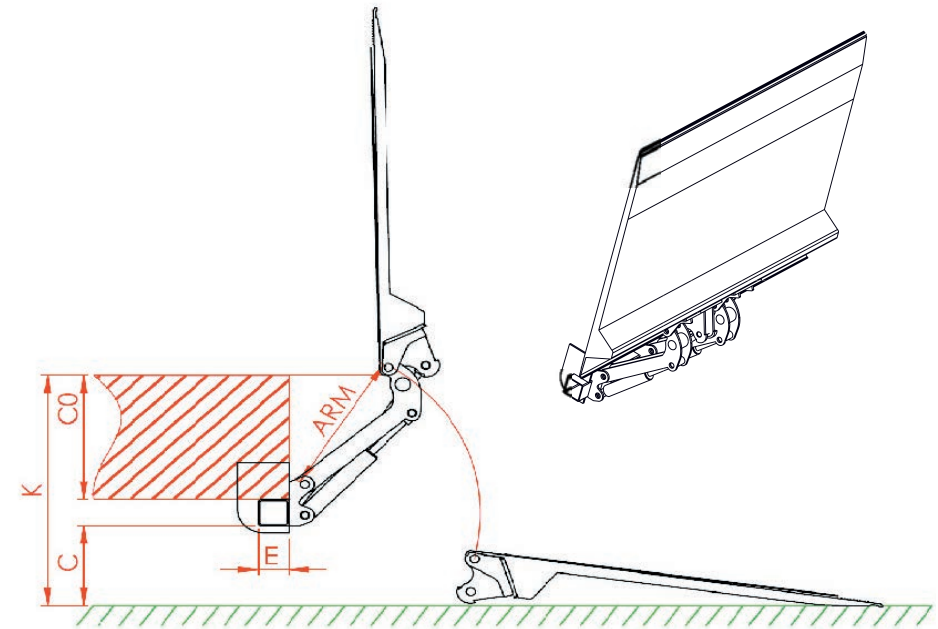



DHL.CL.9010

500 - 750 KG

This model produced for light commercial vehicles, for vans and for low tire diameters vehicles with 500-750 KG loading capacity.

It has 2 different control system.

It can apply Sprinter, Crafter, Hyundai, Transit, Fuso type vehicles.

Lift Type

Light Commercial Vehicle, Outside Mounted, C Fitting Bracket (Small Arm)

Lift Capacity

500-750 kg

Power Source

Battery of Vehicle 12-volt or 24-volt DC

Power Unit

Hydraulic Powerpack

Chassis Profile

120x120

Platform Type

Aluminum

Platform Size

Depends On The Vehicle

Paint Type

Oven Static Paint

Lift Arm Length	700 mm
Max. Lifting	800 x 850 mm
Max. Lowering	350 mm
Chassis Width	650 mm
Chassis Length	1.100 mm
Body Weight	150 kg
Platform Weight	80 kg
Cylinder	2 Lift Cylinder + 2 Tilt Cylinder
Check Valve	4
Platform Size	1.200 x 1.300 mm
Fitting Bracket Max. Space	750 - 860 mm

TECHNICAL SPECIFICATIONS

Lifting Capacity: 500-750 kg
 Working Pressure: 160 Bar
 Loading Center: 600 mm
 Lifting Speed: 0,1 m/s
 Lowering Speed: 0,1 m/s
 Opening-Closing Time: 7-8s
 Platform Working Angle: -10° to +90°
 Power Source: 12-volt / 24-volt DC
 Platform Type: Aluminum
 4 Unit Cylinder
 4 Unit Check Valve
 Hydraulic Powerpack
 Hand Control Unit
 Second Reserve Control Unit

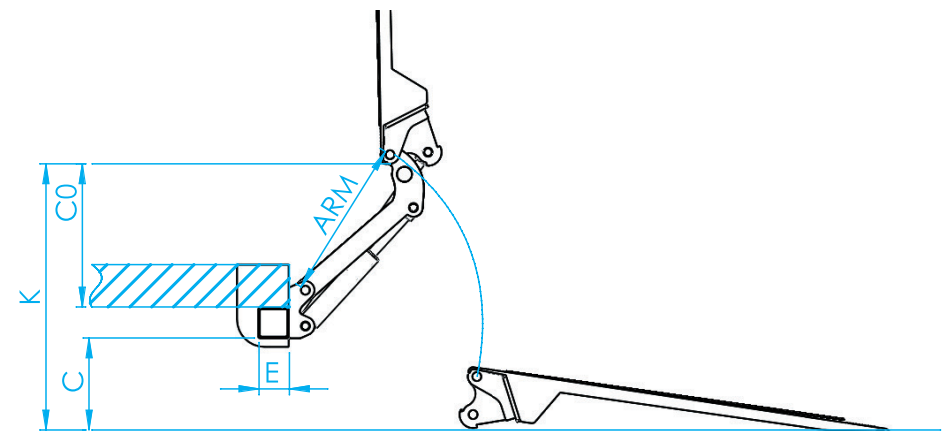



DHL.CL.9011

750 KG

750 KG capacity, mini arm tail lift. It's produced for 3.5 tons 5 tons strait and small chassis vehicles.

It uses C type reverse direction fitting brackets. It has 2 different control system.

Tilt movement works automatically.

Lift Type

Small Arm, C Type Fitting Bracket (Medium)

Lift Capacity

750 kg

Power Source

Battery of Vehicle 12-volt or 24-volt DC

Power Unit

Hydraulic Powerpack

Chassis Profile

120 x 120

Platform Type

Aluminum

Platform Size

2.200 x 1.700 mm - 2.400 x 1.800 mm - 2.500 x 1.800 mm

Paint Type

Oven Static Paint

Lift Arm Length	780 mm
Max. Lifting	900 mm
Max. Lowering	400 mm
Chassis Width	690 mm
Chassis Length	1535 mm
Body Weight	250 kg
Platform Weight	103 kg
Cylinder	2 Lift Cylinder + 2 Tilt Cylinder
Check Valve	4
Platform Size	2.200 x 1.800 mm
Fitting Bracket Max. Space	650 – 890 mm

TECHNICAL SPECIFICATIONS

Lifting Capacity: 500-750 kg
 Working Pressure: 100-160 Bar
 Loading Center: 600 mm
 Lifting Speed: 0,1m/s
 Lowering Speed: 0,1 m/s
 Opening-Closing Time: 6-7s
 Platform Working Angle: -10° to +90°
 Power Source: 12-volt / 24-volt DC
 Platform Type: Aluminum
 E24 TÜV Certified 3 Parts Buffer
 Bolted Type Fitting Bracket
 4 Unit Cylinder
 4 Unit Check Valve
 Hydraulic Powerpack
 Hand Control Unit
 Second Reserve Control Unit

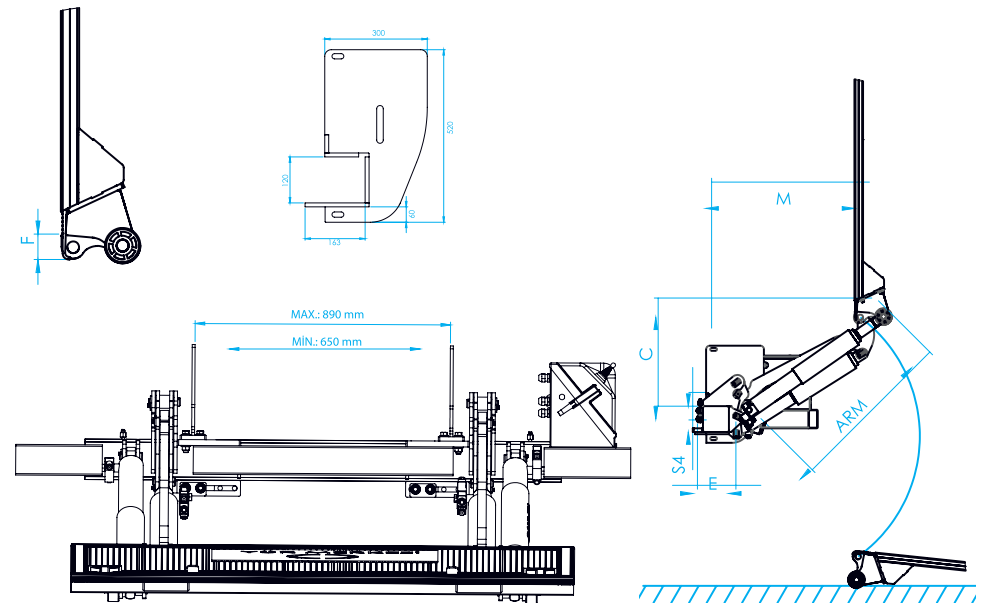



DHL.CL.9012

750 - 1000 KG

750-1.000 KG capacity, mini arm tail lift. It's produced for 3.5 tons - 5 tons strait and small chassis vehicles.

It uses C type reverse direction fitting brackets. It has 2 different control system.

Tilt movement works automatically.

Lift Type
Standard Short Arm. C Type Fitting Bracket (Medium)

Lift Capacity
750 kg - 1.000 kg

Power Source
Battery of Vehicle 12-volt or 24-volt DC

Power Unit
Hydraulic Powerpack

Chassis Profile
120x120

Platform Type
Aluminum

Platform Size
2.200 x 1.700 mm - 2.400 x 1.800 mm -
2.500 x 1.800 mm

Paint Type
Oven Static Paint

Lift Arm Length	780 mm
Max. Lifting	910 mm
Max. Lowering	500 mm
Chassis Width	690 mm
Chassis Length	2.080 mm
Body Weight	180 kg
Platform Weight	103 kg
Cylinder	2 Lift Cylinder + 2 Tilt Cylinder
Check Valve	4
Platform Size	2.200 x 1.800 mm
Fitting Bracket Max. Space	650-890 mm

TECHNICAL SPECIFICATIONS
 Lifting Capacity: 750 - 1.000 kg
 Working Pressure: 100-160 Bar
 Loading Center: 600 mm
 Lifting Speed: 0,1 m/s
 Lowering Speed: 0,1 m/s
 Opening - Closing Time: 6-7s
 Platform working Angle: -10° to +90°
 Power Source: 12- volt / 24-volt DC
 Platform Type: Aluminum
 E24 TÜV Certified 3 Parts Buffer
 Bolted Type Fitting Bracket
 4 Unit Cylinder
 4 Unit Check Valve
 Hydraulic Powerpack
 Hand Control Unit
 Second Reserve Control Unit

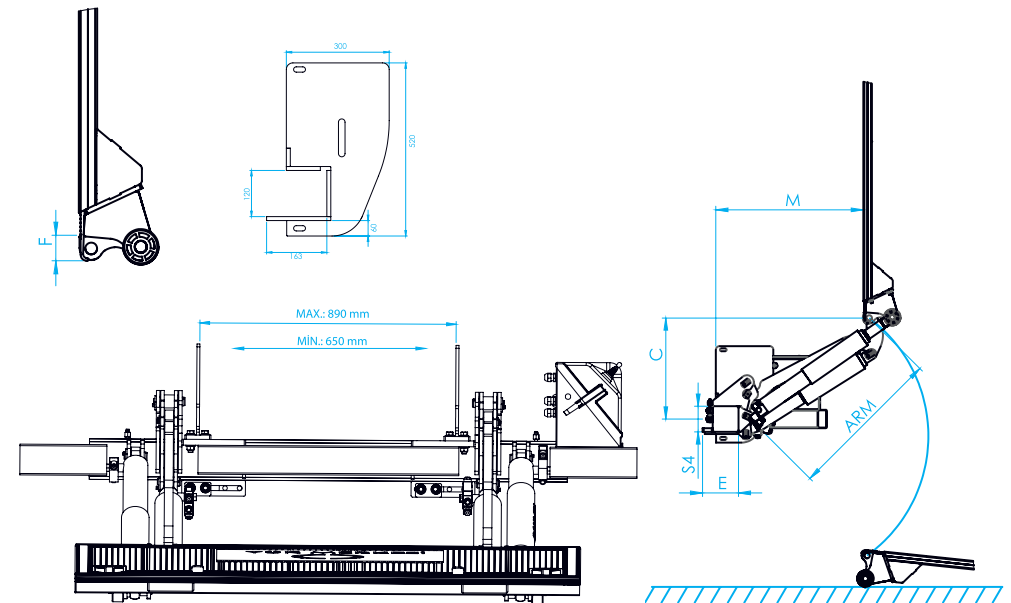



DHL.CL.9013

1500-2000 KG

1500-2000 KG capacity short arm tall lift. It's produced for 5 ton and 12 ton strait chassis vehicles. The system is controlled by the right side of the vehicle.

It has 2 different control system.

Tilt movement works automatically.

Lift Type
Standard Short Arm (Medium)

Lift Capacity
1.500-2.000 kg

Power Source
Battery of Vehicle 12-volt or 24-volt DC

Power Unit
Hydraulic Powerpack

Chassis Profile
140 x140 ST 52

Platform Type
Aluminum

Platform Size
2.200 x 1.700 mm - 2.400 x 1.800 mm -
2.500 x 1.800 mm

Paint Type
Oven Static Paint

Lift Arm Length	780 mm
Max. Lifting	1.100 mm
Max. Lowering	450 mm
Chassis Width	690 mm
Chassis Length	2.080 mm
Body Weight	275 kg
Platform Weight	103 kg
Cylinder	2 Lift Cylinder + 2 Tilt Cylinder
Check Valve	4
Platform Size	2200 x 1.800 mm
Fitting Bracket Max. Space	650-900 mm

TECHNICAL SPECIFICATIONS

Lifting Capacity: 1.500-2.000 kg
Working Pressure: 160-180 Bar
Loading Center: 600 mm
Lifting Speed: 0,1 m/s
Opening - Closing Time: 7-8 s
Platform Working Angle: -10° to +90°
Power Source: 12-volt / 24-volt DC
E24 TÜV Certified 3 Parts Buffer
Bolted Type Fitting Bracket
4 Unit Cylinder
4 Unit Check Valve
Hydraulic Powerpack
Hand Control Unit
Second Reserve Control Unit

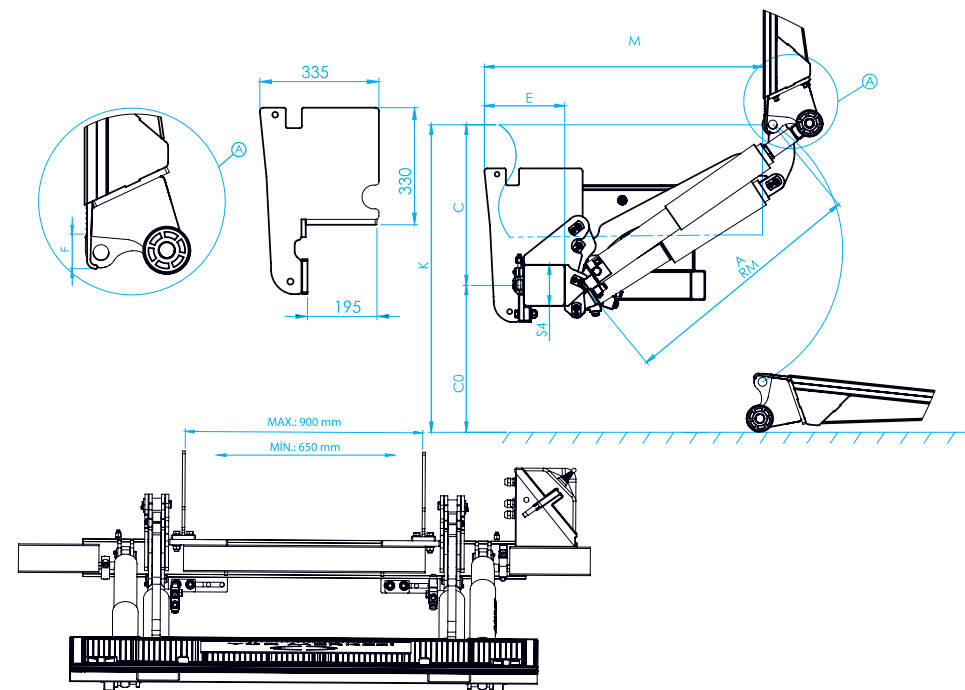



DHL.CL.9014

1500 KG

1500 KG capacity, long arm tail lift. It's produced for 5 ton and 12 ton wide chassis vehicles.

The system is controlled by the right side of the vehicle.

It has 2 different control system.

Tilt movement works automatically.

Lift Type
Standard Long Arm (Large)

Lift Capacity
1.500 kg

Power Source
Battery of Vehicle 12-volt or 24-volt DC

Power Unit
Hydraulic Powerpack

Chassis Profile
140 x140 ST 52

Platform Type
Aluminum

Platform Size
2.200 x 1.700 mm - 2.400 x 1.800 mm -
2.500 x 1.800 mm

Paint Type
Oven Static Paint

Lift Arm Length	910 mm
Max. Lifting	1.400 mm
Max. Lowering	500 mm
Chassis Width	800 mm
Chassis Length	2.270 mm
Body Weight	310 kg
Platform Weight	108 kg
Cylinder	2 Lift Cylinder + 2 Tilt Cylinder
Check Valve	4
Platform Size	2.500 x 1.800 mm
Fitting Bracket Max. Space	900-1100 mm

TECHNICAL SPECIFICATIONS
 Lifting Capacity: 1.500 kg
 Working Pressure: 160-180 Bar
 Loading Center: 600 mm
 Lifting Speed: 0,1 m/s
 Lowering Speed: 0,1 m/s
 Opening-Closing Time: 7-8s
 Platform Working Angle: -10° to +90°
 Power Source: 12-volt / 24-volt DC
 Platform Type: Aluminum
 E24 TÜV Certified 3 Parts Buffer
 Bolted Type Fitting Bracket
 4 Unit Cylinder
 4 Unit Check Valve
 Hydraulic Powerpack
 Hand Control Unit
 Second Reserve Control Unit

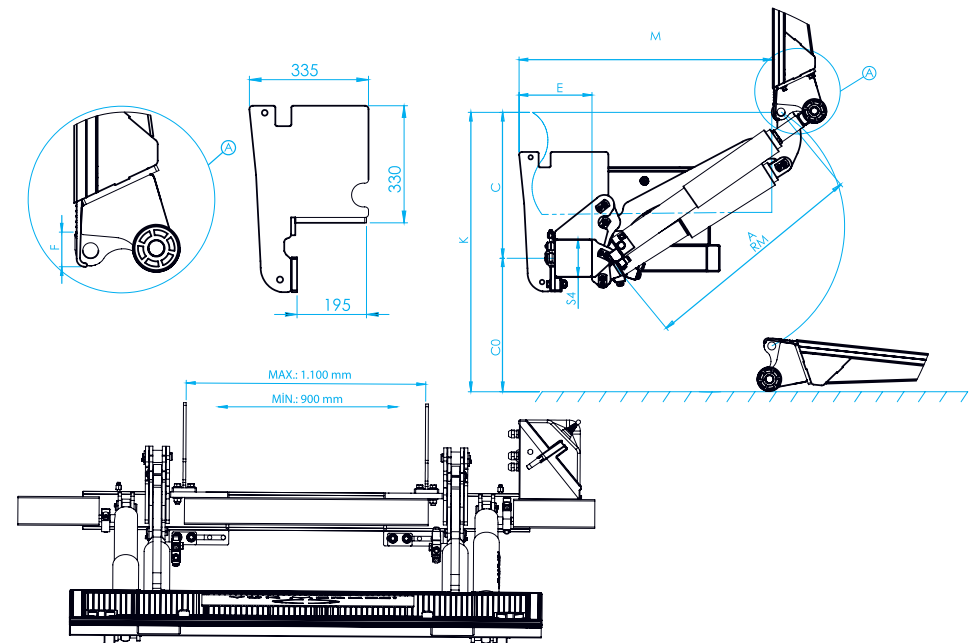



DHL.CL.9015

2000 KG

2000 KG capacity, long arm tail lift. It's produced for 5 ton and 18 ton wide chassis vehicles.

The system is controlled by the right side of the vehicle.

It has 2 different control system.

Tilt movement works automatically.

Lift Type
Standard Long Arm (Large)

Lift Capacity
2.000 kg

Power Source
Battery of Vehicle 12-volt or 24-volt DC

Power Unit
Hydraulic Powerpack

Chassis Profile
140 x140 ST 52

Platform Type
Aluminum

Platform Size
2.200 x 1.700 mm - 2.400 x 1.800 mm -
2.500 x 1.800 mm

Paint Type
Oven Static Paint

Lift Arm Length	910 mm
Max. Lifting	1.400 mm
Max. Lowering	500 mm
Chassis Width	800 mm
Chassis Length	2.700 mm
Body Weight	310 kg
Platform Weight	110 kg
Cylinder	2 Lift Cylinder + 2 Tilt Cylinder
Check Valve	4
Platform Size	2.600 x 1800 mm
Fitting Bracket Max. Space	900 - 1.100 mm

TECHNICAL SPECIFICATIONS

Lifting Capacity: 2.000 kg
Working Pressure: 160 - 180 Bar
Loading Center: 600 mm
Lifting Speed: 0,1 m/s
Lowering Speed: 0,1 m/s
Opening-Closing Time: 7-8 s
Platform Working Angle: -10° to 90°
Power Source: 12-volt / 24-volt DC
Platform Type: Aluminum
E24 TOV Certified 3 Parts Buffer
Bolted Type Fitting Bracket
4 Unit Cylinder
4 Unit Check Valve
Hydraulic Powerpack
Hand Control Unit
Second Reserve Control Unit

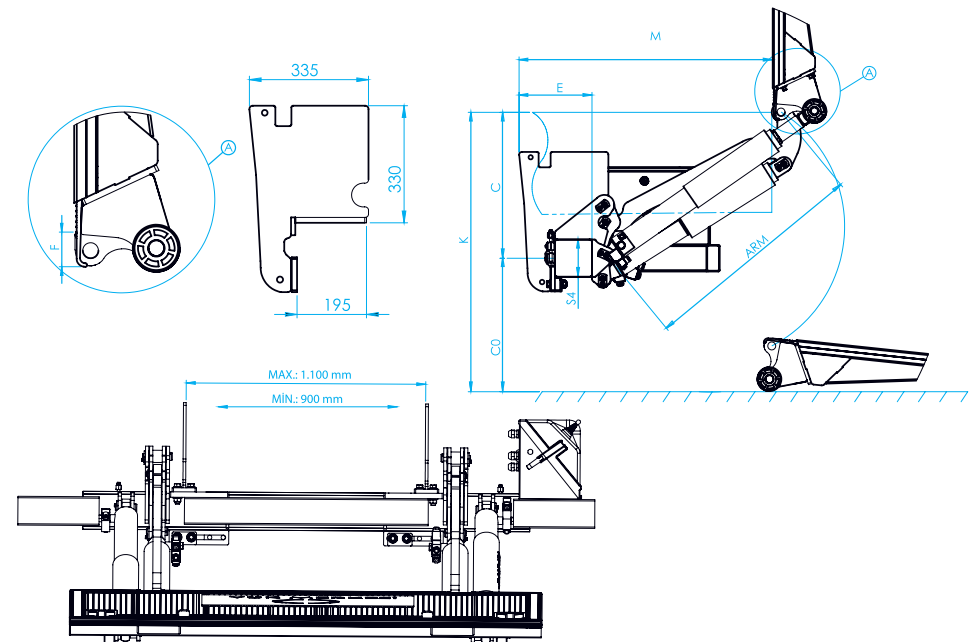



DHL.CL.9016

1000 - 1500 - 2000 KG

2000 KG capacity, long arm tail lift. It's produced for 5 ton and 18 ton wide chassis vehicles.

Euro lift has full options; Remote control, hand control, foot control, roll stop and warning lamps.

The system is controlled by the right side of the vehicle.

It has 2 different control system.

Tilt movement works automatically.

Lift Type

Euro (Long Arm and Short Arm)
(Medium - Large)

Lift Capacity

1.000 - 1.500 - 2.000 kg

Power Source

Battery of Vehicle 12-volt or 24-volt DC

Power Unit

Hydraulic Powerpack

Chassis Profile

140 x140 ST 52

Platform Type

Aluminum + Foot Control + Warning Lamp
+ Roll Stop

Platform Size

2.200 x 1.700 mm - 2.400 x 1.800 mm -
2.500 x 1.800 mm

Paint Type

Oven Static Paint

Lift Arm Length	780 mm - 910 mm
Max. Lifting	1.400 mm
Max. Lowering	500 mm
Chassis Width	800 mm
Chassis Length	2.270 mm
Body Weight	310 kg
Platform Weight	110 kg
Cylinder	2 Lift Cylinder + 2 Tilt Cylinder
Check Valve	4
Platform Size	2.500 x 1.800 mm
Fitting Bracket	740 - 980 mm
Max. Space	900 - 1.100 mm

TECHNICAL SPECIFICATIONS

Lifting Capacity: 2.000 kg
Working Pressure: 160-180 Bar
Loading Center: 600 mm
Lifting Speed: 0,1 m/s
Lowering Speed: 0,1 m/s
Opening-Closing Time: 7-8s
Platform Working Angle: -10° to 90°
Power Source: 12-volt / 24-volt DC
Platform Type: Aluminum
E24 TÜV Certified 3 Parts Buffer
Bolted Type Fitting Bracket
4 Unit Cylinder
4 Unit Check Valve
Hydraulic Powerpack
Hand Control Unit
Remote Control
Foot Control
Warning Lamp
Roll Stop

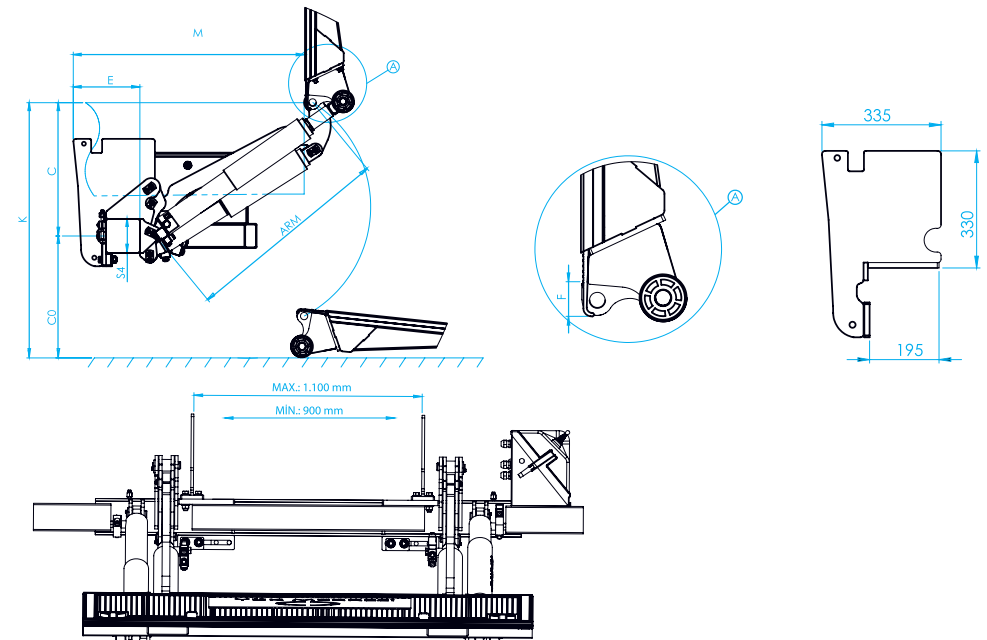



DHL.CL.9017

1500-2000 KG

1500 – 2000 KG capacity, long arm tail lift. It's produced for 12 ton and 18 ton trailer type wide chassis vehicles.

Suitable for trailer wide chassis space and height, arm size called XL.

Lift Type
Standard Long Arm (XL)

Lift Capacity
1.500 - 2.000 kg

Power Source
Battery of Vehicle 12-volt or 24-volt DC

Power Unit
Hydraulic Powerpack

Chassis Profile
140 x140 ST 52

Platform Type
Aluminum

Platform Size
2.200 x 1.700 mm - 2.400 x 1.800 mm -
2.500 x 1.800 mm

Paint Type
Oven Static Paint

Lift Arm Length	910 mm
Max. Lifting	1.500 mm
Max. Lowering	500 mm
Chassis Width	800 mm
Chassis Length	2.650 mm
Body Weight	335 kg
Platform Weight	110 kg
Cylinder	2 Lift Cylinder + 2 Tilt Cylinder
Check Valve	4
Platform Size	2.600 x 1.800 mm
Fitting Bracket Max. Space	1.150 - 1.350 mm

TECHNICAL SPECIFICATIONS

Lifting Capacity: 2.000 kg
Working Pressure: 160 - 180 Bar
Loading Center: 600 mm
Lifting Speed: 0,1 m/s
Lowering Speed: 0,1 m/s
Opening-Closing Time: 7-8 s
Platform Working Angle: -10° to 90°
Power Source: 12-volt / 24-volt DC
Platform Type: Aluminum
E24 TOV Certified 3 Parts Buffer
Bolted Type Fitting Bracket
4 Unit Cylinder
4 Unit Check Valve
Hydraulic Powerpack
Hand Control Unit
Second Reserve Control Unit

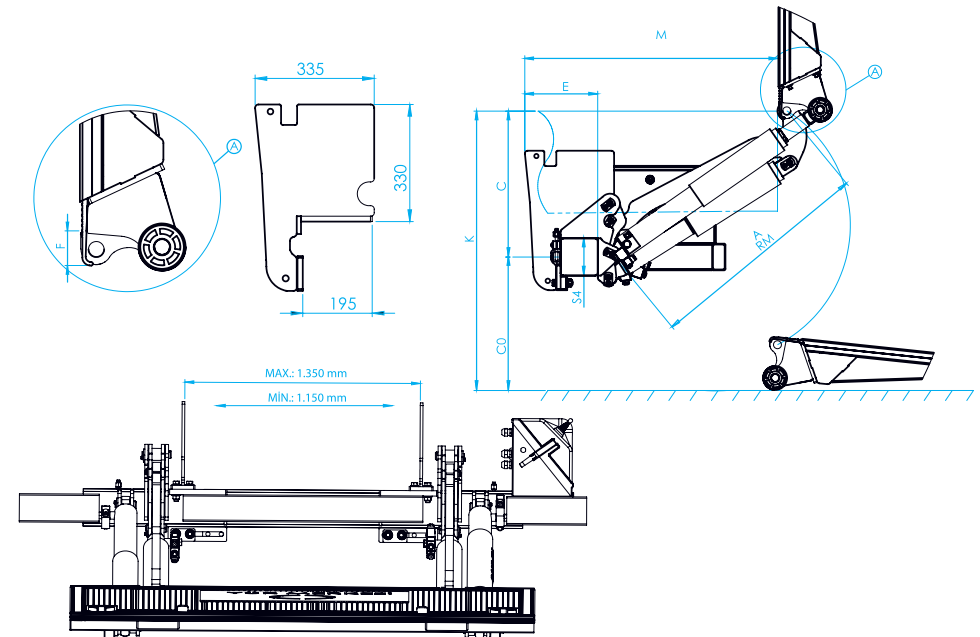



DHL.SL.9020

1500-2000 KG

1500 – 2000 KG capacity, slider tail lift for trucks. It's produced for 12 ton and 18 ton wide chassis vehicles.

The system is controlled by the right side of the vehicle.

It has 2 different control system.

Tilt movement works automatically.

Lift Type
Standard Slider Lift

Lift Capacity
1.500 - 2.000 kg

Power Source
Battery of Vehicle 12-volt or 24-volt DC

Power Unit
Hydraulic Powerpack

Chassis Profile
140 x140 ST 52

Platform Type
Aluminum

Platform Size
2.200 x 1.700 mm - 2.400 x 1.800 mm -
2.500 x 1.800 mm

Paint Type
Oven Static Paint

Lift Arm Length	910 mm
Max. Lifting	1.500 mm
Max. Lowering	580 mm
Chassis Width	2.000 mm
Chassis Length	2.650 mm
Body Weight	452 kg
Platform Weight	130 kg
Cylinder	2 Lift Cylinder + 2 Tilt Cylinder + 2 Forward - Back Cylinder
Check Valve	4
Platform Size	2.600 x 1.800 mm
Fitting Bracket Max. Space	1.150 - 1.350 mm

TECHNICAL SPECIFICATIONS
 Lifting Capacity: 1.500 - 2.000 kg
 Working Pressure: 160-180 Bar
 Loading Center: 600 mm
 Lifting Speed: 0,1 m/s
 Lowering Speed: 0,1 m/s
 Opening-Closing Time: 7-8s
 Platform Working Angle: -10° to 90°
 Power Source: 12-volt / 24-volt DC
 Platform Type: Aluminum
 E24 TÜV Certified 3 Parts Buffer
 Bolted Type Fitting Bracket
 6 Unit Cylinder
 4 Unit Check Valve
 Hydraulic Powerpack
 Hand Control Unit
 Second Reserve Control Unit

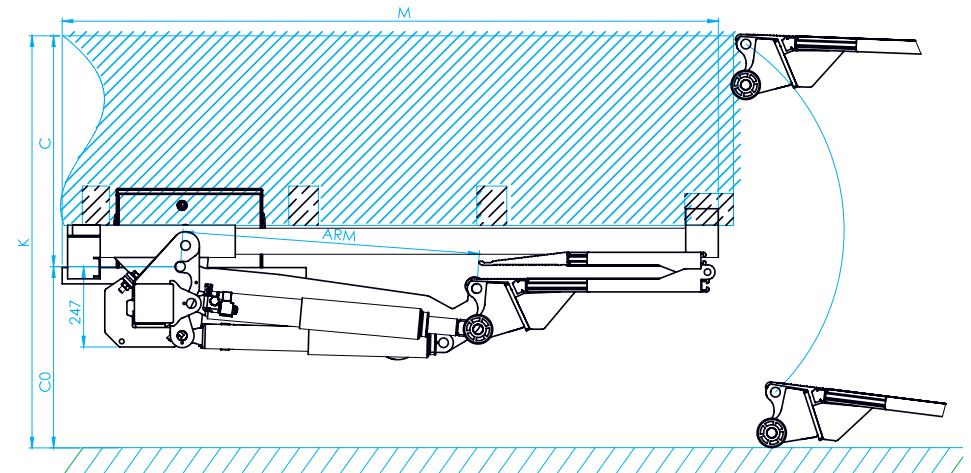



DHL.F.9030

1500-2000 KG

1500-2000 KG capacity, short arm tail lift. It's produced for 7 ton and 12 ton wide chassis vehicles.

It has steel folding platform. The system is controlled by the right side of the vehicle.

It has 2 different control system.

Tilt movement works automatically.

Lift Type

Standard Short Arm, Folding and Steel Platform (Medium)

Lift Capacity

1.500 - 2.000 kg

Power Source

Battery of Vehicle 12-volt or 24-volt DC

Power Unit

Hydraulic Powerpack

Chassis Profile

140 x140 ST 52

Platform Type

Steel

Platform Size

Depends On The Vehicle

Paint Type

Oven Static Paint

Lift Arm Length	780 mm
Max. Lifting	1.400 mm
Max. Lowering	500 mm
Chassis Width	800 mm
Chassis Length	2.080 mm
Body Weight	310 kg
Platform Weight	375 kg
Cylinder	2 Lift Cylinder + 2 Tilt Cylinder
Check Valve	4
Platform Size	2.400 x 1.800 mm
Fitting Bracket Max. Space	740 - 980 mm

TECHNICAL SPECIFICATIONS

Lifting Capacity: 1.500 - 2.000 kg
 Working Pressure: 160-180 Bar
 Loading Center: 600 mm
 Lifting Speed: 0,1 m/s
 Lowering Speed: 0,1 m/s
 Opening-Closing Time: 7-8s
 Platform Working Angle: -10° to 90°
 Power Source: 12-volt / 24-volt DC
 Platform Type: Steel
 E24 TÜV Certified 3 Parts Buffer
 Bolted Type Fitting Bracket
 4 Unit Cylinder
 4 Unit Check Valve
 Hydraulic Powerpack
 Hand Control Unit
 Second Reserve Control Unit

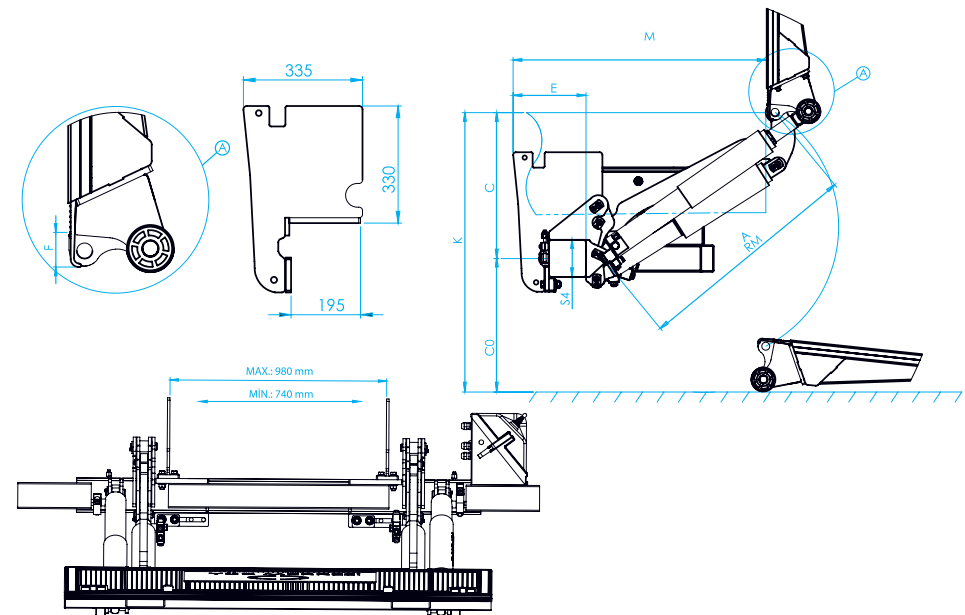



DHL.LT.9040

1500-2000 KG

1500 - 2000 KG capacity, long arm tail lift. It's produced for 7 ton and 12 ton wide chassis vehicles. It uses steel platform. The system is controlled by the right side of the vehicle.

It has 2 different control system.

Tilt movement works automatically.

Lift Type
Standard Long Arm, Steel Platform (Large)

Lift Capacity
1.500 - 2.000 kg

Power Source
Battery of Vehicle 12-volt or 24-volt DC

Power Unit
Hydraulic Powerpack

Chassis Profile
140 x140 ST 52

Platform Type
Steel, for tube transport vehicle

Platform Size
2.000 X 1800 or Depends On The Vehicle

Paint Type
Oven Static Paint

Lift Arm Length	910 mm
Max. Lifting	1.500 mm
Max. Lowering	500 mm
Chassis Width	800 mm
Chassis Length	2.080 mm
Body Weight	275 kg
Platform Weight	375 kg
Cylinder	2 Lift Cylinder + 2 Tilt Cylinder
Check Valve	4
Platform Size	Depends On The Vehicle
Fitting Bracket Max. Space	740 - 980 mm

TECHNICAL SPECIFICATIONS
 Lifting Capacity: 1.500 - 2.000 kg
 Working Pressure: 160-180 Bar
 Loading Center: 600 mm
 Lifting Speed: 0,1 m/s
 Lowering Speed: 0,1 m/s
 Opening-Closing Time: 7-8s
 Platform Working Angle: -10° to 90°
 Power Source: 12-volt / 24-volt DC
 Platform Type: Steel
 E24 TÜV Certified 3 Parts Buffer
 Bolted Type Fitting Bracket
 4 Unit Cylinder
 4 Unit Check Valve
 Hydraulic Powerpack
 Hand Control Unit
 Second Reserve Control Unit

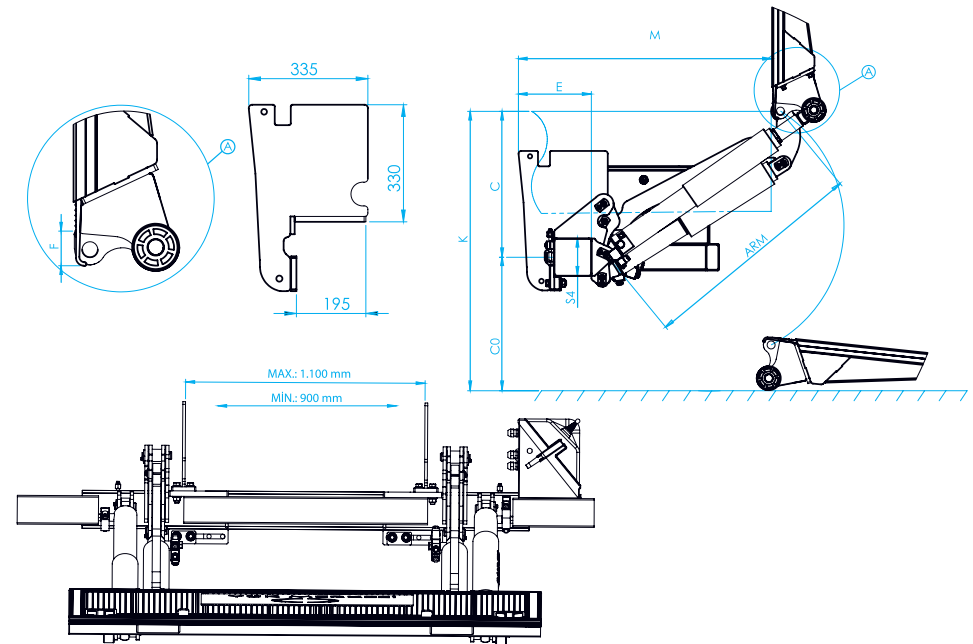



DHL.CLM.9050

1000 KG

The capacity of column lift is 500-1000 KG.

It can apply all kind of vehicle.

System works with 2 cylinders.

It's very reliable about safety and stability.

Lift can be mountable to back of the vehicle or one side of the vehicle.

Lift Type
Column Type

Lift Capacity
1.000 kg

Power Source
Battery of Vehicle 12 volt or 24-volt DC

Power Unit
Hydraulic Powerpack

Chassis Profile
Mounted on the Vehicle Body

Platform Type
Aluminum

Platform Size
Depends On The Vehicle

Paint Type
Oven Static Paint

Lift Arm Length

Max. Lifting 1.500 mm

Max. Lowering 1.500 mm

Chassis Width Vehicle Case

Chassis Length

Body Weight Depends On The Vehicle

Platform Weight Depends On The Vehicle

Cylinder 2 Lift Cylinder +
2 Opening-Closing Cylinder

Check Valve 2

Platform Size Depends On The Vehicle

Fitting Bracket
Max. Space

TECHNICAL SPECIFICATIONS

Lifting Capacity: 1.000 kg
Working Pressure: 160 Bar
Loading Center: 600 mm
Lifting Speed: 0,1 m/s
Lowering Speed: 0,1 m/s
Opening - Closing Time: 7-8s
Platform Working Angle: 90°
Power Source: 12 volt-24-volt DC
Platform Type: Aluminum
2 Unit Opening-Closing Cylinder
2 Unit Check Valve
Hydraulic Powerpack
Hand Control Unit
Second Reserve Control Unit

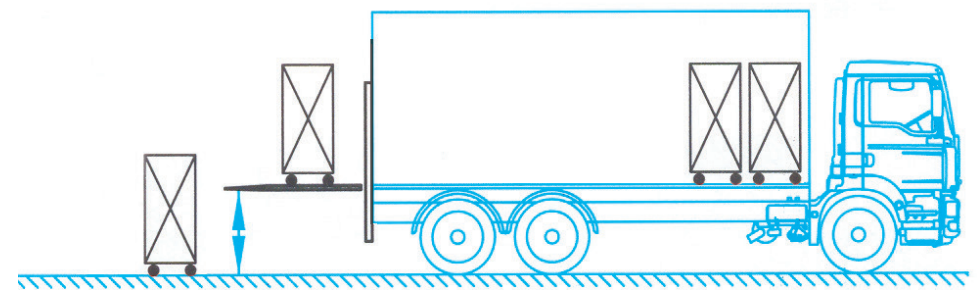

TRANSPALLET PLATFORM

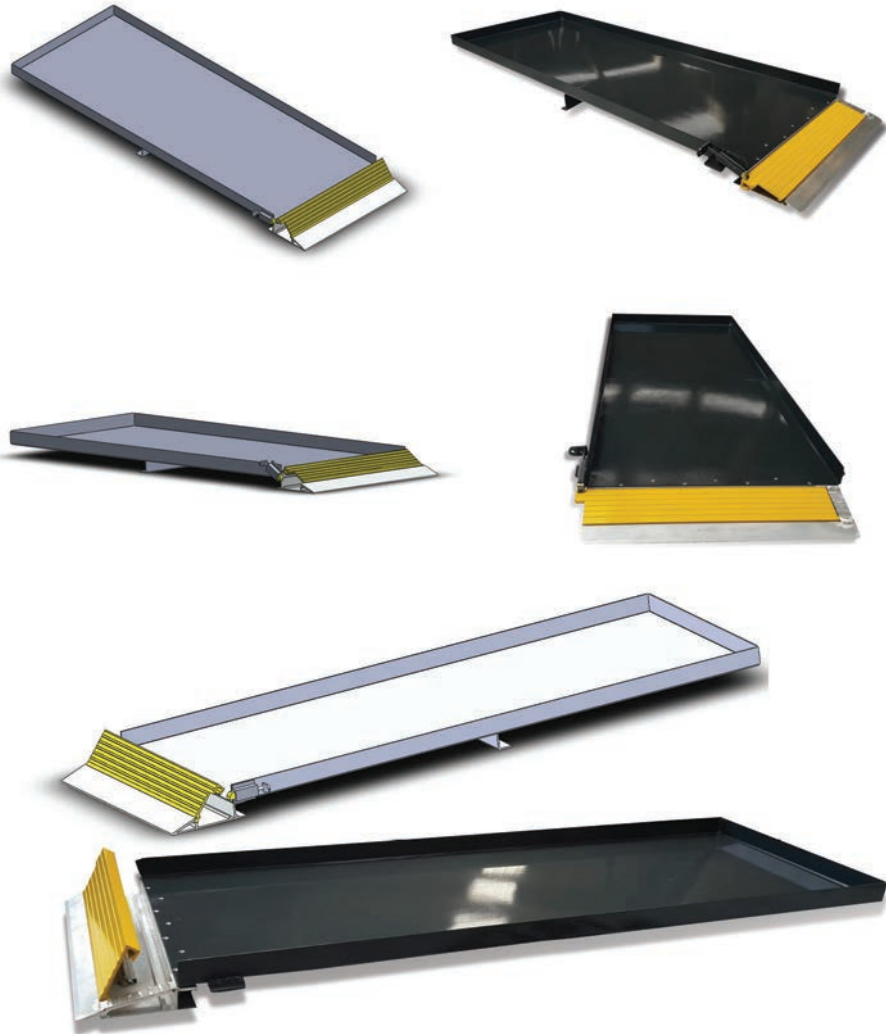

WHEELCHAIR LIFTS



DHL.7002

350 KG

Single arm wheelchair lift can be used for buses and mini-buses. It is possible to mounting lift from the side door or back door of the vehicle. Lifting - lowering and roll stop works automatically.

Platform of the lift folding manually. There is a hand pump on the system for if there is any problem, user can lift the system with this hand pump. With manual discharge of check valve lift can be lowering easily. It has working lamp, working alarm, emergency button and required check valves.

Lift Type
Single Arm Wheelchair Lift

Lift Capacity
350 kg

Power Source
Battery of Vehicle 12-volt or 24-volt DC

Power Unit
Hydraulic Powerpack

Chassis Profile
Mounted on the floor of the vehicle

Platform Type
Aluminum or steel

Platform Size
1.260 x 800 mm

Paint Type
Oven Static Paint

Lift Arm Length	920 - 650 mm
Max. Lifting	700 mm
Max. Lowering	700 mm
Chassis Width	320 x 515 mm
Chassis Length	920 mm
Total Weight	110 kg
Cylinder	1 Cylinder
Platform Size	800 x 1.200 mm

TECHNICAL SPECIFICATIONS

Lifting Capacity: 350 kg
Working Pressure: 60 Bar
Power Source: 12-volt / 24-volt DC
Platform Type: Aluminum
1 Unit Cylinder
1 Unit Check Valve
Hydraulic Powerpack
Hand Control Unit
Remote Control
Warning Lamp
Alarm
Emergency Button

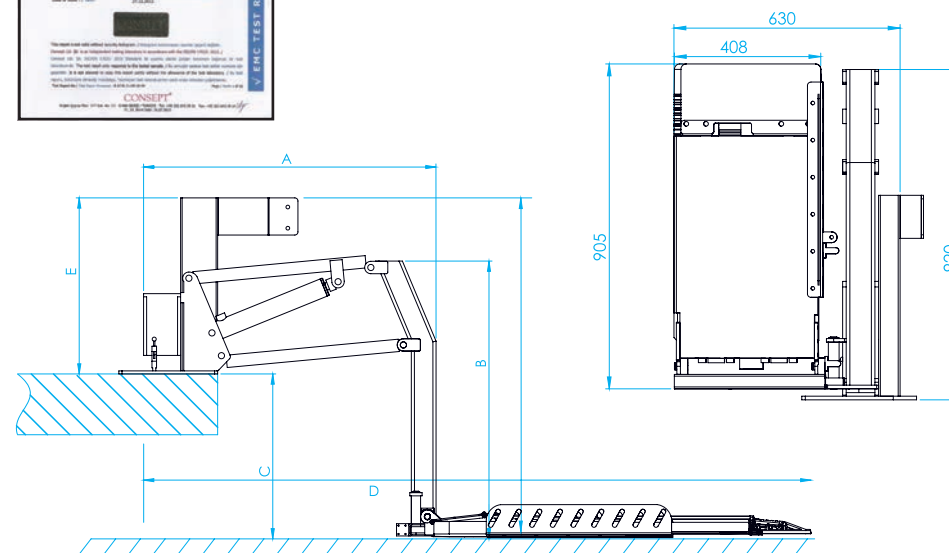
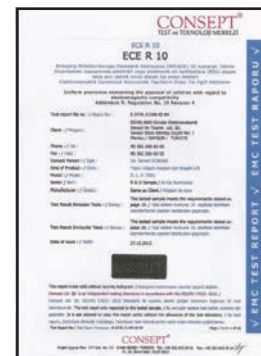



DHL.7003

350 KG

Single arm wheelchair lift can be used for buses and mini-buses. It is possible to mounting lift from the side door or back door of the vehicle. Lifting- lowering and roll stop works automatically. Platform folding automatically and it is swivel table. There is a hand pump on the system for if there is any problem, you can lift the system with this hand pump. With manual discharge of check valve lift can be lowering easily. It has working lamp, working alarm, emergency button and required check valves.

Lift Type
Automatic Single Arm Wheelchair Lift

Lift Capacity
350 kg

Power Source
Battery of Vehicle 12-volt or 24-volt DC

Power Unit
Hydraulic Powerpack

Chassis Profile
Mounted on the floor of the vehicle

Platform Type
Aluminum

Platform Size
1.260 x 800 mm

Paint Type
Oven Static Paint

Lift Arm Length	920 mm
Max. Lifting	700 mm
Max. Lowering	700 mm
Chassis Width	320 x 650 mm
Chassis Length	920 mm
Total Weight	110 kg
Cylinder	1 Cylinder
Check Valve	1
Platform Size	800 x 1.200 mm

TECHNICAL SPECIFICATIONS

Lifting Capacity: 350 kg
 Working Pressure: 60 Bar
 Opening-Closing Time: 7-8s
 Platform Working Angle: 90°
 Power Source: 12-volt / 24-volt DC
 Platform Type: Aluminum
 1 Unit Cylinder
 1 Unit Check Valve
 Hydraulic Powerpack
 Hand Control Unit
 Remote Control
 Warning Lamp
 Alarm
 Emergency Button

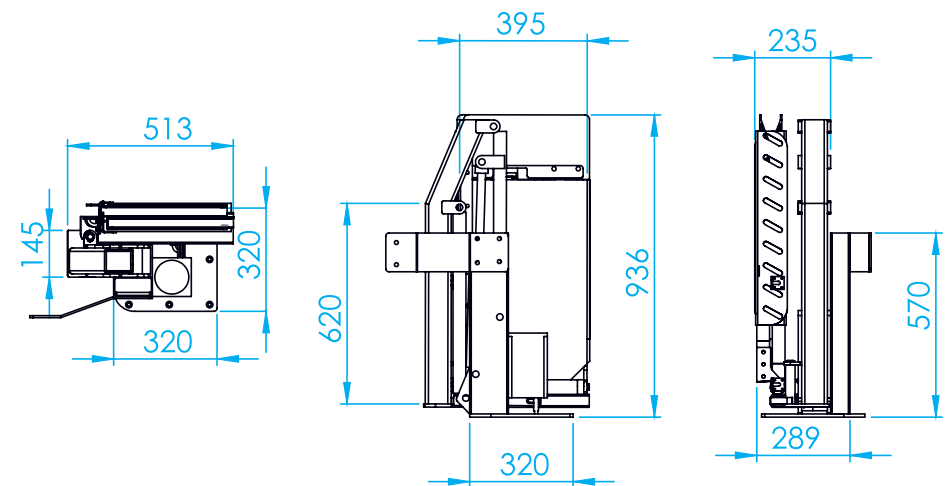



DHL.7004

350 KG

Single arm wheelchair lift can be used for buses and mini-buses. It is possible to mounting lift from the side door or back door of the vehicle. Lifting lowering and roll stop works automatically. Sliding platform enters nested. It is swivel table and opening-closing works manually. With manual discharge of check valve lift can be lowering easily.

It has working lamp, working alarm, emergency button and required check valves.

Lift Type

Single Arm Sliding and Folding Wheelchair Lift

Lift Capacity

350 kg

Power Source

Battery of Vehicle 12-volt or 24-volt DC

Power Unit

Hydraulic Powerpack

Chassis Profile

Mounted on the floor of the vehicle

Platform Type

Aluminum or steel

Platform Size

1.260 x 800 mm

Paint Type

Oven Static Paint

Lift Arm Length	920 mm
Max. Lifting	700 mm
Max. Lowering	700 mm
Chassis Width	320 x 515 mm
Chassis Length	920 mm
Total Weight	110 kg
Cylinder	1 Cylinder
Check Valve	1
Platform Size	800 x 1.200 mm

TECHNICAL SPECIFICATIONS

Lifting Capacity: 350 kg
 Working Pressure: 60 Bar
 Opening-Closing Time: 7-8s
 Platform Working Angle: +90°
 Power Source: 12-volt / 24-volt DC
 Platform Type: Aluminum or Steel
 1 Unit Cylinder
 1 Unit Check Valve
 Hydraulic Powerpack
 Hand Control Unit
 Remote Control
 Warning Lamp
 Alarm
 Emergency Button

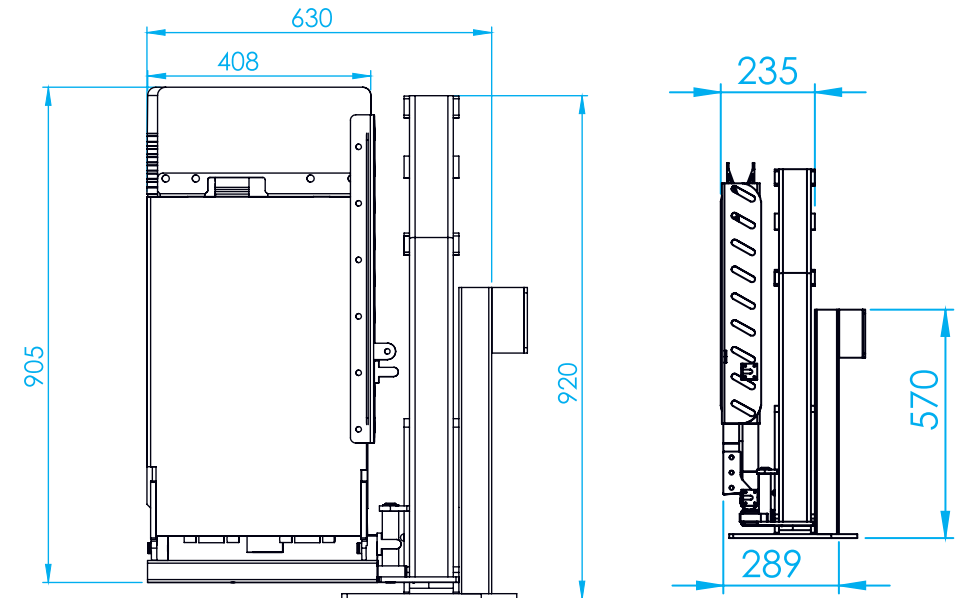



DHL.7005

350-400 KG

Double arm wheelchair lift can be used for buses and mini-buses. It is mounting from the back door of the vehicle. Lifting-lowering, opening-closing and roll stop works automatically.

Platform opening-closing works automatically. With manual discharge of check valve lift can be lowering easily. It has working lamp, working alarm, emergency button and required check valves.

Lift Type
Double Arm Automatic Wheelchair Lift

Lift Capacity
350 kg

Power Source
Battery of Vehicle 12-volt or 24-volt DC

Power Unit
Hydraulic Powerpack

Chassis Profile
Mounted on the floor of the vehicle

Platform Type
Aluminum or steel

Platform Size
1.260 x 800 mm

Paint Type
Oven Static Paint

Lift Arm Length	950 mm
Max. Lifting	750 x 850 mm
Max. Lowering	700 mm
Chassis Width	335 x 1.700 mm
Chassis Length	1.500 mm
Total Weight	130 kg
Cylinder	2 Cylinder
Check Valve	2
Platform Size	1.200 x 1.500 mm

TECHNICAL SPECIFICATIONS

Lifting Capacity: 350-400 kg
 Working Pressure: 60 Bar
 Opening-Closing Time: 7-8s
 Platform Working Angle: 90°
 Power Source: 12 volt-24 volt DC
 Platform Type: Aluminum or Steel
 2 Unit Cylinder
 2 Unit Check Valve
 Hydraulic Powerpack
 Hand Control Unit
 Remote Control
 Warning Lamp
 Alarm
 Emergency Button

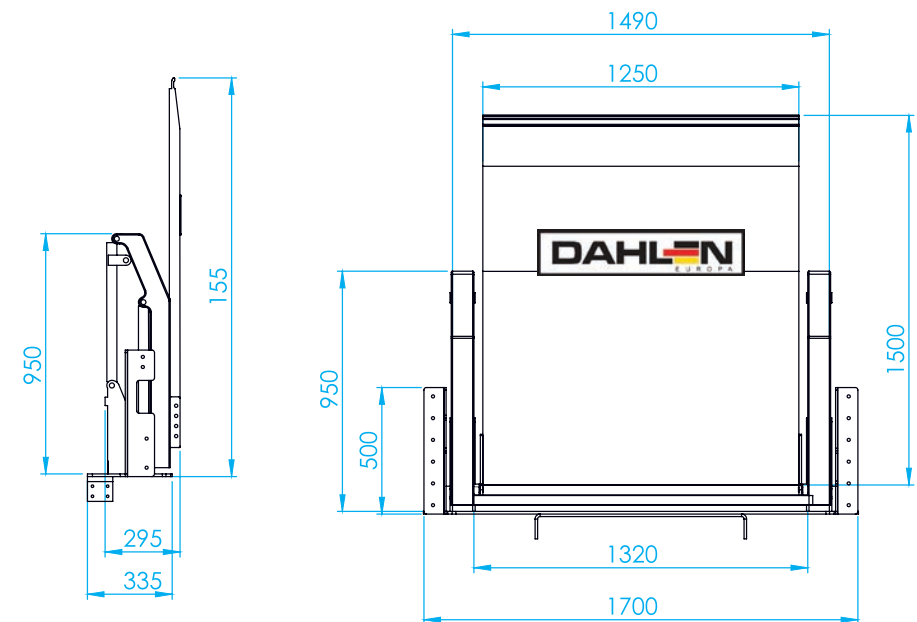



DHL.7006

350-400 KG

Double arm wheelchair lift can be used for buses and mini-buses. It is mounting from the back door of the vehicle. Lifting- lowering, opening-closing and roll stop works automatically.

Platform folding works manual. With manual discharge of check valve lift can be lowering easily. It has working lamp, working alarm, emergency button and required check valves.

Lift Type

Double Arm Folding Platform Wheelchair Lift

Lift Capacity

350 kg

Power Source

Battery of Vehicle 12-volt or 24-volt DC

Power Unit

Hydraulic Powerpack

Chassis Profile

Mounted on the floor of the vehicle

Platform Type

Aluminum or steel

Platform Size

1.260 x 800 mm

Paint Type

Oven Static Paint

Lift Arm Length	990 mm
Max. Lifting	750 x 850 mm
Max. Lowering	700 mm
Chassis Width	335 mm
Chassis Length	850 mm
Total Weight	130 kg
Cylinder	2 Cylinder
Check Valve	2
Platform Size	800 x 1.200 mm

TECHNICAL SPECIFICATIONS

Lifting Capacity: 350 -400 kg
 Working Pressure: 60 Bar
 Opening-Closing Time: 7-8 s
 Platform Working Angle: 90°
 Power Source: 12-volt 24-volt DC
 Platform Type: Aluminum or Steel
 2 Unit Cylinder
 2 Unit Check Valve
 Hydraulic Powerpack
 Hand Control Unit
 Remote Control
 Warning Lamp
 Alarm
 Emergency Button

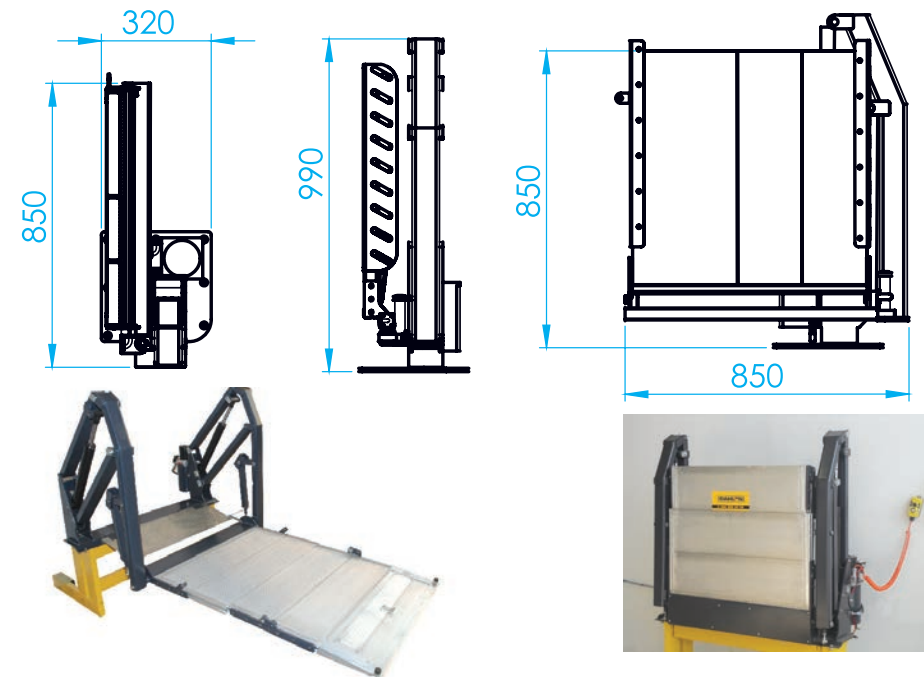

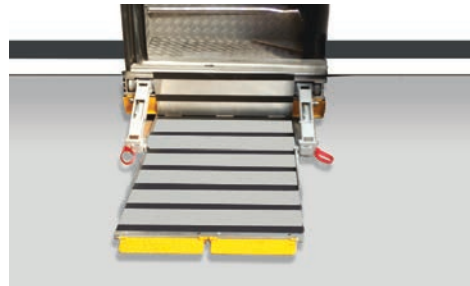

DHL.CASSETTE.8000-8010

350 KG

Cassette lift for mini-buses. Its lighter weight and easy assembled than the alternative products. DAHLEN cassette lift has CE and EMC certificate.

Lift Capacity
350 kg

Lift Arm Length	500 mm
Max. Lifting	700 x 750 mm
Max. Lowering	250 mm
Chassis Width	1.200 mm
Chassis Length	810 mm
Total Weight	140 kg
Cylinder	2 Cylinder
Platform Size	800 x 1.200 mm

TECHNICAL SPECIFICATIONS

- Lifting Capacity: 350 kg
- Working Pressure: 60 Bar
- Power Source: 12-volt / 24-volt DC
- Platform Type: Aluminum
- 2 Unit Cylinder
- 2 Unit Check Valve
- Hydraulic Powerpack
- Hand Control Unit
- Remote Control

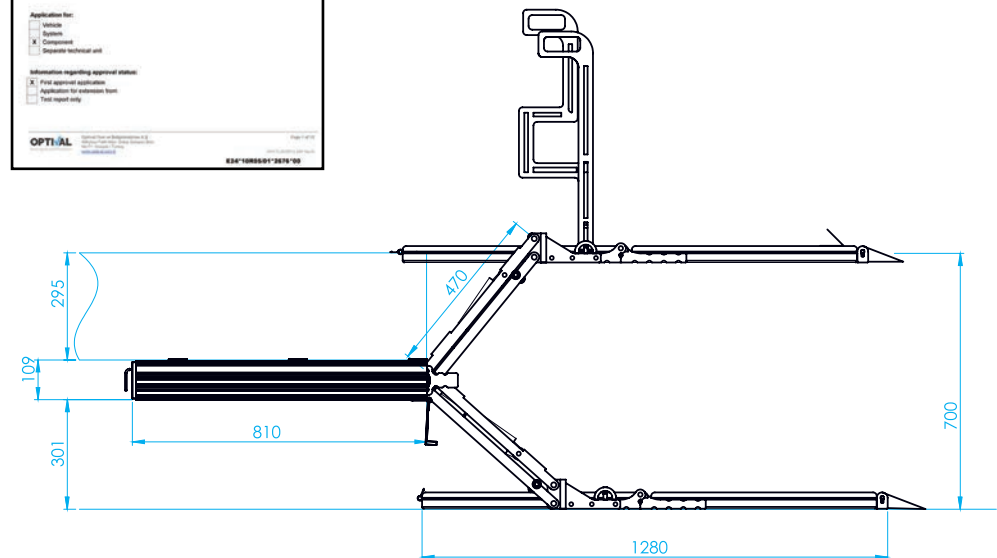

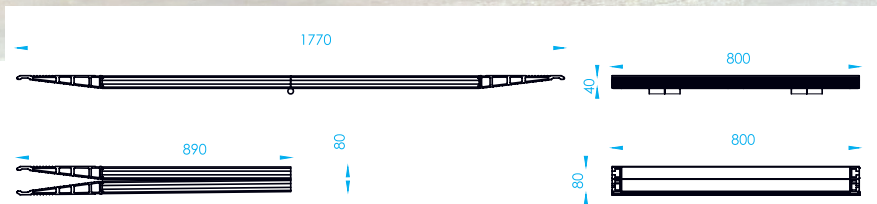

DHL.7007

350-400 KG

WHEELCHAIR RAMP

Aluminum wheelchair ramp is your economic solution partner. Foldable, light weight, practice and does not take the place inside of the vehicle.

Lift Type
Wheelchair Ramp

Lift Capacity
350 - 400 kg

Platform Type
Aluminum

Platform Size
800 x 1.770 mm

SCISSOR LIFT & DOCK LEVELLER

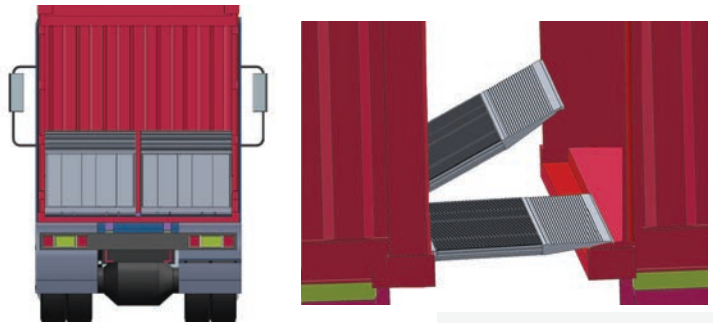
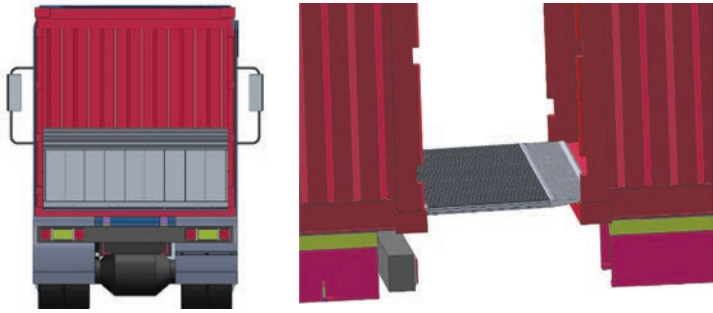

DHL.DL.4001

TECHNICAL SPECIFICATIONS

This loading bridge enables the operator to shift load from the truck to the trailer and vice versa and also to handle all the loading and unloading at the rear of the trailer, either by means of a tail lift or at the loading dock. The Dahlen Loading Bridge consists of 2 hinged ramps of 1250mm x 2200mm and 4 hinged ramps of 1250mm x 1200mm which are manipulated by hand from a vertical travel position just inside the rear doors of the truck body to a horizontal work position between the 2 vehicles and manually works.

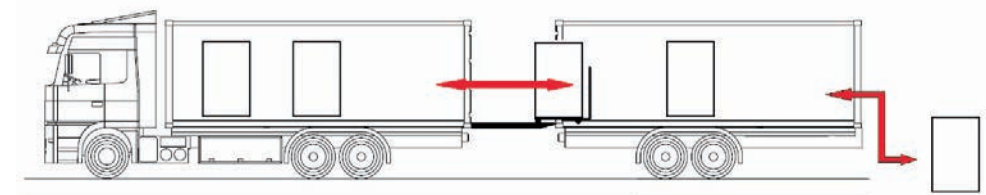
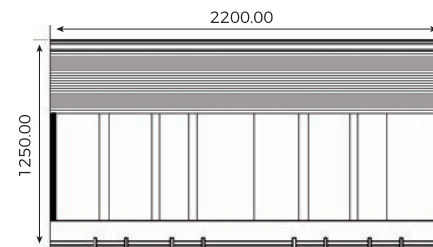
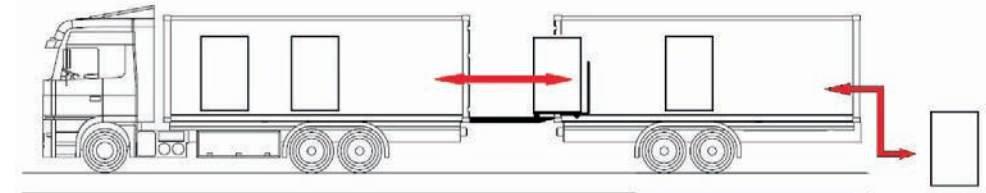
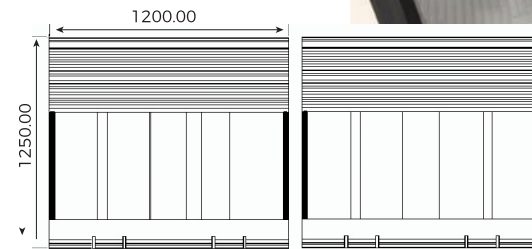

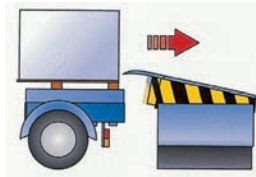
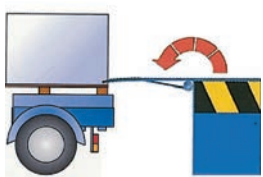

DHL.DL.4004

Hinged Type Dock Leveller

Lift Type
Hinged Type Dock Leveller

Platform Size
2.500 x 3.000 mm
2.600 x 3.300 mm

Can be produced according to your demand.



DHL.SL.6200

500-3000 KG

SCISSOR LIFT

Height When Closed
40-45cm

Lifting Height
90cm

Power Unit
Hydraulic

Powerpack Type
Single Act

Capacity
1000 kg

Working Voltage
12-24 Volt DC, 220-380 Volt AC

Platform Size
According To Demand



POWERPACK

POWERPACKS DC MOTORS SPARE PARTS

DHL.H90.1000 FULL UNIT

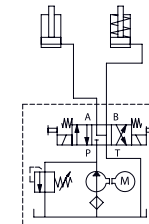

TYPE	: DLP TYPE SINGLE ACT-DOUBLE OUTPUT
VOLT	: 12 - 24 V
POWER	: 2.2 KW
PRESSURE	: 250 Bar (Max.)
LITRE	: 6 lt
PUMP	: 1.8 cc - 2.2 cc
DIRECTION	
SIZE	: 45 x 23 x 28,5 cm

DHL.H90.1010 FULL UNIT MLS

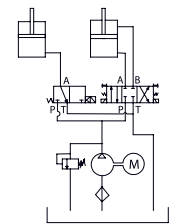

TYPE	: SINGLE AND DOUBLE ACT THREE OUTPUT
VOLT	: 12 - 24 V
POWER	: 2.5 KW
PRESSURE	: 250 Bar (Max.)
LITRE	: 6 lt
PUMP	: 1.8 cc - 2.2 cc
DIRECTION	
SIZE	: 45 x 23 x 28,5 cm

DHL.H90.1020

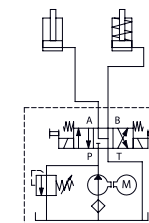

TYPE	: SINGLE ACT-DOUBLE OUTPUT
VOLT	: 12 - 24 V
POWER	: 2.5 KW
PRESSURE	: 250 Bar (Max.)
LITRE	: 6 lt
PUMP	: 1.8 cc - 2.2 cc
DIRECTION	
SIZE	: 42 x 27 x 20 cm

DHL.H90.1030

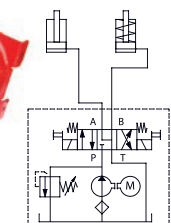

TYPE	: SINGLE ACT-DOUBLE OUTPUT
VOLT	: 12 - 24 V
POWER	: 3 KW
PRESSURE	: 250 Bar (Max.)
LITRE	: 10-15 lt
PUMP	: 1.8 cc - 2.2 cc
DIRECTION	
SIZE	: 40 X 21,5 X 29 cm

POWERPACK

DHL.H90.1040

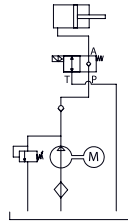

TYPE	: MINI TYPE
VOLT	: 12 - 24 V
POWER	: 0,5 KW
PRESSURE	: 100 Bar (Max.)
LITRE	: 3 lt
PUMP	: 0.50 cc
DIRECTION	
SIZE	: 35 X 12,5 X 20 cm

DHL.H90.1050 WITH FAN

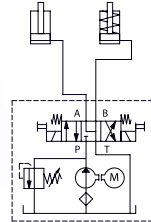

TYPE	: SINGLE ACT-DOUBLE OUTPUT
VOLT	: 12 - 24 V
POWER	: 4,5 KW
PRESSURE	: 250 Bar (Max.)
LITRE	: WITHOUT TANK
PUMP	: 3,5 cc
DIRECTION	
SIZE	: 40 x 15,5 x 15,5 cm

POWERPACK

DHL.H90.1080 FULL UNIT

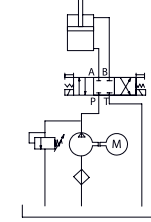

TYPE	: DOUBLE ACT-DOUBLE OUTPUT
VOLT	: 12 - 24 V
POWER	: 2,2 KW
PRESSURE	: 250 Bar (Max.)
LITRE	: 6 lt
PUMP	: 1,8 cc - 2,2 cc
DIRECTION	
SIZE	: 45 x 23 x 28,5 cm

DHL.H90.1090 WITH FAN

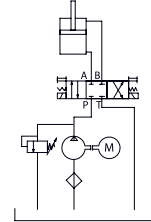
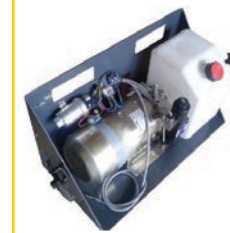

TYPE	: LOWBED TPE -DOUBLE ACT
VOLT	: 12 - 24 V
POWER	: 4,5 KW
PRESSURE	: 250 Bar (Max.)
LITRE	: 6 lt
PUMP	: 3,5 cc
DIRECTION	
SIZE	: 52 x 30 x 30 cm

DHL.H90.1060

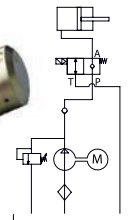

TYPE	: SINGLE ACT
VOLT	: 12 - 24 V
POWER	: 2,2 KW
PRESSURE	: 250 Bar (Max.)
LITRE	: 8 lt
PUMP	: 1,8 cc - 2,2 cc
DIRECTION	
SIZE	: 49 x 19,5 x 19,5 cm

DHL.H90.1070

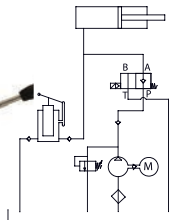
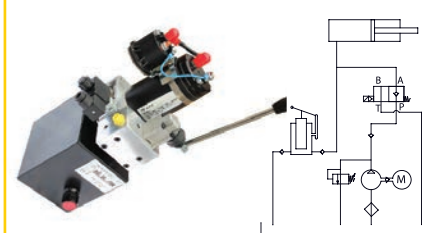

TYPE	: MINI TYPE - WITH HAND PUMP
VOLT	: 12 - 24 V
POWER	: 0,75 KW
PRESSURE	: 100 Bar (Max.)
LITRE	: 3 lt
PUMP	: 0,50 cc
DIRECTION	
SIZE	: 42 x 20 x 15 cm

DHL.H90.1100

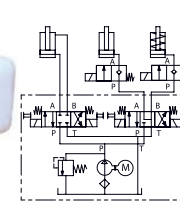

TYPE	: SINGLE AND DOUBLE OUTPUT
VOLT	: 12 - 24 V
POWER	: 2,2 KW
PRESSURE	: 250 Bar (Max.)
LITRE	: 6 lt
PUMP	: 1,8 cc - 2,2 cc
DIRECTION	
SIZE	: 50 x 25 x 18 cm

DHL.H90.1110

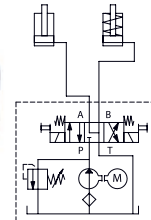

TYPE	: SINGLE ACT-DOUBLE OUTPUT
VOLT	: 12 - 24 V
POWER	: 2,2 KW
PRESSURE	: 250 Bar (Max.)
LITRE	: 8 lt
PUMP	: 1,8 cc - 2,2 cc
DIRECTION	
SIZE	: 56 x 25 x 18 cm

POWERPACK

DHL.H90.1120

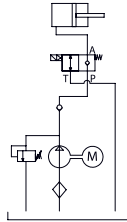

TYPE	: UNIVERSAL TYPE
VOLT	: 12 - 24 V
POWER	: 2.2 KW
PRESSURE	: 170 Bar (Max.)
LITRE	: 10 - 15 lt
PUMP	: 2.2 cc
DIRECTION	
SIZE	: 60 x 24 x 24 cm

DHL.H90.1130 WITH FAN

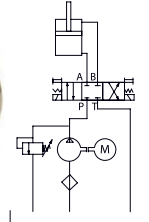

TYPE	: DOUBLE OUTPUT
VOLT	: 12 - 24 V
POWER	: 4.5 KW
PRESSURE	: 250 Bar (Max.)
LITRE	: WITHOUT TANK
PUMP	: 3.5 cc
DIRECTION	
SIZE	: 40 x 17 x 17 cm

POWERPACK

DHL.H90.1160

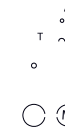

TYPE	: SINGLE ACT
VOLT	: 12 - 24 V DC - 220 - 380 V AC
POWER	: 2.2 KW
PRESSURE	: 250 Bar (Max.)
LITRE	: 8 lt
PUMP	: 1.8 cc
DIRECTION	
SIZE	: 49 x 19,5 x 19,5 cm

DHL.H90.1170

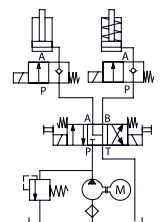
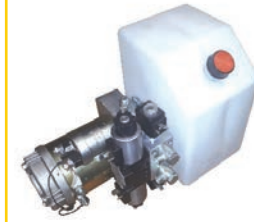

TYPE	: SINGLE ACT-DOUBLE OUTPUT
VOLT	: 12 - 24 V
POWER	: 2.2 KW
PRESSURE	: 250 Bar (Max.)
LITRE	: 6 lt
PUMP	: 3.5 cc
DIRECTION	
SIZE	: 40 x 15,5 x 15,5 cm

DHL.H90.1140 WITH FAN



TYPE	: TOWER ROTATION
VOLT	: 12 - 24 V
POWER	: 1.5 KW
PRESSURE	: 170 Bar (Max.)
LITRE	: WITHOUT TANK
PUMP	: 1.0 cc
DIRECTION	
SIZE	: 12 x 38 x 20 cm

DHL.H90.1150 WITH FAN

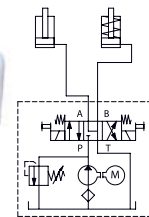

TYPE	: SINGLE ACT-DOUBLE OUTPUT
VOLT	: 12 - 24 V
POWER	: 2.2 KW
PRESSURE	: 250 Bar (Max.)
LITRE	: 8 lt
PUMP	: 2 cc
DIRECTION	
SIZE	: 56 x 25 x 18 cm

DHL.H90.1180 ZEPRO MODEL

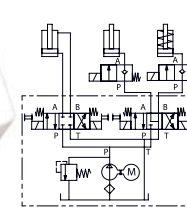

TYPE	: DOUBLE ACT - 4 OUTPUT
VOLT	: 12 - 24 V
POWER	: 2.2 KW
PRESSURE	: 250 Bar (Max.)
LITRE	: 6 lt
PUMP	: 3.5 cc
DIRECTION	
SIZE	: 40 x 15,5 x 15,5 cm

DHL.H90.1200 FULL UNIT

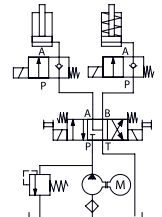

TYPE	: SINGLE ACT-DOUBLE OUTPUT
VOLT	: 12 - 24 V
POWER	: 2.2 KW
PRESSURE	: 250 Bar (Max.)
LITRE	: 6 lt
PUMP	: 3.5 cc
DIRECTION	
SIZE	: 40 x 15,5 x 15,5 cm

DC MOTOR

DHL-020-0001 (12 VOLT)
DHL-020-0002 (24 VOLT)



DC MOTOR

MODEL : DLP NEW MODEL
VOLT : 12 - 24 V
POWER : 1.8 KW - 2.2 KW
REV : 3500 - 2000 d/d
DIRECTION : RIGHT - ONE WAY (CW)
SHAFT TYPE : MALE
SIZE : 115 x 190 mm

DHL-020-0003 (12 VOLT)
DHL-020-0004 (24 VOLT)



DC MOTOR

MODEL : ISKRA-PALFINGER
ANTEO-BOSCH TYPE
VOLT : 12 - 24 V
POWER : 1.8 KW - 2.2 KW
REV : 3500 - 2000 d/d
DIRECTION : RIGTH OR LEFT WAY (CW)
SHAFT TYPE : MALE
SIZE : 115 x 190 mm

DC MOTOR

DHL-020-0011 (12 VOLT)
DHL-020-0012 (24 VOLT)



DC MOTOR

MODEL : MARIN ITALIAN TYPE
VOLT : 12 - 24 V
POWER : 2.5 KW - 3.0 KW
REV : 3500 - 2000 d/d
DIRECTION : RIGHT - LEFT DOUBLE WAY
SHAFT TYPE : WEDGE
SIZE : 120 x 190 x 144 mm

DHL-020-0013 (12 VOLT)
DHL-020-0014 (24 VOLT)



DC MOTOR

MODEL : ISKRA-MLS-DHOLLANDIA TYPE
VOLT : 12 - 24 V
POWER : 1.8 KW - 2.2 KW
REV : 3500 - 2000 d/d
DIRECTION : RIGHT - ONE WAY (CW)
SHAFT TYPE : FEMALE
SIZE : 115 x 190 mm

DHL-020-0007 (12 VOLT)
DHL-020-0008 (24 VOLT)



DC MOTOR

MODEL : MARIN TYPE
VOLT : 12 - 24 V
POWER : 1.8 KW - 2.2 KW
REV : 3500 - 2000 d/d
DIRECTION : RIGHT - LEFT DOUBLE WAY
SHAFT TYPE : WEDGE
SIZE : 115 x 190 x 122 mm

DHL-020-0009 (12 VOLT)
DHL-020-0010 (24 VOLT)



DC MOTOR

MODEL : MARIN ITALIAN TYPE
VOLT : 12 - 24 V
POWER : 1.8 KW - 2.2 KW
REV : 3500 - 2000 d/d
DIRECTION : RIGHT - LEFT DOUBLE WAY
SHAFT TYPE : WEDGE
SIZE : 115 x 190 x 144 mm

DHL-020-0015 (12 VOLT)
DHL-020-0016 (24 VOLT)



DC MOTOR

MODEL : DLP OLD MODEL
VOLT : 12 - 24 V
POWER : 2.5 KW - 3.0 KW
REV : 3500 - 2000 d/d
DIRECTION : RIGHT - ONE WAY (CW)
SHAFT TYPE : MALE
SIZE : 120 x 190 mm

DHL-020-0017 (12 VOLT)
DHL-020-0018 (24 VOLT)



DC MOTOR

MODEL : MINI UNIVERSAL TYPE
VOLT : 12 - 24 V
POWER : 0.5 KW
REV : 2500 d/d
DIRECTION : RIGHT - ONE WAY (CW)
SHAFT TYPE : WEDGE
SIZE : 81 x 160 x 80 mm

DC MOTOR

DHL-020-0019 (12 VOLT)
DHL-020-0020 (24 VOLT)



DC MOTOR WITH FAN

MODEL : POWERPACK TYPE
VOLT : 12 - 24 V
POWER : 3.5 KW - 4.5 KW
REV : 6000 - 2500 d/d
DIRECTION : RIGHT - ONE WAY (CW)
SHAFTTYPE : POWERPACK
SIZE : 150 x 260 mm

DHL-020-0021 (12 VOLT)
DHL-020-0022 (24 VOLT)



DC MOTOR WITH FAN

MODEL : BOSCH TYPE
VOLT : 12 - 24 V
POWER : 1.8 KW - 2.2 KW
REV : 3500 - 2000 d/d
DIRECTION : RIGHT - ONE WAY (CW)
SHAFTTYPE : MALE
SIZE : 115 x 210 mm

DC MOTOR

DHL-020-0027 (12 VOLT)
DHL-020-0028 (24 VOLT)



DC MOTOR

MODEL : ZEPRO TYPE
VOLT : 12 - 24 V
POWER : 1.8 KW - 2.2 KW
REV : 3500 - 2000 d/d
DIRECTION : RIGHT - ONE WAY (CW)
SHAFTTYPE : FREZE
SIZE : 115 x 190 mm

DHL-020-0029 (12 VOLT)
DHL-020-0030 (24 VOLT)



DC MOTOR

MODEL : QUICK TYPE
VOLT : 12 - 24 V
POWER : 1.8 KW - 2.2 KW
REV : 3500 - 2000 d/d
DIRECTION : RIGHT - LEFT DOUBLE WAY
SHAFTTYPE : WEDGE
SIZE : 115 x 190 mm

DHL-020-0023 (12 VOLT)
DHL-020-0024 (24 VOLT)



DC MOTOR

MODEL : BOSCH TYPE
VOLT : 12 - 24 V
POWER : 1.8 KW - 2.2 KW
REV : 3500 - 2000 d/d
DIRECTION : RIGHT - LEFT DOUBLE WAY
SHAFTTYPE : FEMALE
SIZE : 115 x 190 mm

DHL-020-0025 (12 VOLT)
DHL-020-0026 (24 VOLT)



DC MOTOR

MODEL : ISKRA-ANTEO
PALFINGER TYPE
VOLT : 12 - 24 V
POWER : 1.8 KW - 2.2 KW
REV : 3500 - 2000 d/d
DIRECTION : RIGHT - ONE WAY (CW)
SHAFTTYPE : MALE
SIZE : 115 x 190 mm

DHL-020-0031 (12 VOLT)
DHL-020-0032 (24 VOLT)



DC MOTOR

MODEL : ISKRA-MLS-DHOLLANDIA TYPE
VOLT : 12 - 24 V
POWER : 1.8 KW - 2.2 KW
REV : 3500 - 2000 d/d
DIRECTION : RIGHT - ONE WAY (CW)
SHAFTTYPE : FEMALE
SIZE : 115 x 190 mm

DHL-020-0033 (24 VOLT)



DC MOTOR WITH FAN

MODEL : QUICK TYPE
VOLT : 12 - 24 V
POWER : 1.8 KW - 2.2 KW
REV : 3500 - 2000 d/d
DIRECTION : RIGHT - LEFT DOUBLE WAY
SHAFTTYPE : WEDGE
SIZE : 115 x 190 mm

DC MOTOR

DHL-020-0034 (24 VOLT)



DC MOTOR

MODEL : Military Type
 VOLT : 12 - 24 V
 POWER : 1.8 KW - 2.2 KW
 REV : 3500 - 2000 d/d
 DIRECTION : RIGHT - ONE WAY (CW)
 SHAFT TYPE : FEMALE
 SIZE : 115 x 190 mm

DHL-020-0035 (12 VOLT)
DHL-020-0036 (24 VOLT)

DC MOTOR

MODEL : PASARELLA TYPE
 VOLT : 12 - 24 V
 POWER : 1.8 - 2.2 KW
 REV : 3500 - 2000 d/d
 DIRECTION : RIGHT - ONE WAY (CW)
 SHAFT TYPE : MALE SHORT SHAFT
 SIZE : 115 x 190 mm

DC MOTOR

DHL-020-0041 (12 VOLT)
DHL-020-0042 (24 VOLT)

DC MOTOR

MODEL : REXROTH-BOSCH-ATK TYPE
 VOLT : 12 - 24 V
 POWER : 1.8 KW - 2.2 KW
 REV : 3500 - 2000 d/d
 DIRECTION : LEFT - ONE WAY (CCW)
 SHAFT TYPE : FEMALE
 SIZE : 115 x 190 mm

DHL-020-0043 (12 VOLT)
DHL-020-0044 (24 VOLT)

DC MOTOR

MODEL : REXROTH-BOSCH-ATK TYPE
 VOLT : 12 - 24 V
 POWER : 1.8 KW - 2.2 KW
 REV : 3500 - 2000 d/d
 DIRECTION : LEFT - ONE WAY (CCW)
 SHAFT TYPE : MALE
 SIZE : 115 x 190 mm

DHL-020-0037 (12 VOLT)
DHL-020-0038 (24 VOLT)

DC MOTOR

MODEL : PASARELLA TYPE
 VOLT : 12 - 24 V
 POWER : 1.8 - 2.2 KW
 REV : 3500 - 2000 d/d
 DIRECTION : RIGHT - ONE WAY (CW)
 SHAFT TYPE : MALE LONG SHAFT
 SIZE : 115 x 190 mm

DHL-020-0039 (12 VOLT)
DHL-020-0040 (24 VOLT)

DC MOTOR

MODEL : BOSCH TYPE
 VOLT : 12 V - 24 V
 POWER : 0.8 KW
 REV : 1500 d/d
 DIRECTION : RIGHT - ONE WAY (CW)
 SHAFT TYPE : FEMALE
 SIZE : 170 X 70 mm

DHL-020-0045 (12 VOLT)
DHL-020-0046 (24 VOLT)

DC MOTOR

MODEL : ISKRA-DHOLLANDIA TYPE
 VOLT : 12 - 24 V
 POWER : 1.8 KW - 2.2 KW
 REV : 3500 - 2000 d/d
 DIRECTION : LEFT OR RIGHT ONE WAY
 SHAFT TYPE : FEMALE
 SIZE : 115 x 190 mm

DHL-020-0047 (12 VOLT)
DHL-020-0048 (24 VOLT)

DC MOTOR

MODEL : PALFINGER TYPE
 VOLT : 12 - 24 V
 POWER : 1.8 KW - 2.2 KW
 REV : 3500 - 2000 d/d
 DIRECTION : LEFT - ONE WAY (CCW)
 SHAFT TYPE : FEMALE
 SIZE : 115 x 190 mm

DC MOTOR

DHL-020-0050



DC MOTOR WITH MAGNETIC BRAKE

MODEL : FORKLIFT - TRANSPALLET TYPE
 VOLT : 24 V
 POWER : 1 KW
 REV : 2.600 d/d
 DIRECTION : DOUBLE WAY
 SHAFT TYPE :
 SIZE : 230x180x280 mm

DHL-020-0060



MAGNETIC BRAKE SYSTEM

MODEL : BRAKE
 VOLT : 24 V DC
 POWER : 25 W
 BREAKING TORQUE : 12 Nm
 DIRECTION : One Way
 BORE DIAMETER : 40 mm

DHL.H90.1200



PUMP 1,8 CC - 2,2 CC

DHL.H90.1201



PUMP 2,5 CC SIDE OUT

DHL.H90.1203



PUMP 0,75 CC

DHL.H90.1210



HAND PUMP UNF 3/4

DHL.H90.1220



Max. Flow: 12 L/m
 Max. Working Pressure: 50 bar

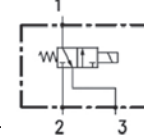

POPET VALVE 3/2

DHL.H90.1230



Max. Flow: 40 L/m
 Max. Working Pressure: 350 bar

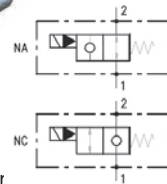

POPET VALVE 2/2 | NORMALLY CLOSED

DHL.H90.1240



Max. Flow: 30-60 L/m
 Max. Working Pressure.: 315 bar

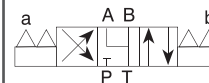

NG-6 DOUBLE WAY VALVE | NORMALLY OPEN

DHL.H90.1241



Max. Flow: 30-60 L/m
 Max. Working Pressure.: 315 bar

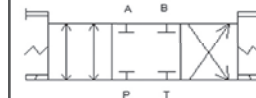

NG-6 DOUBLE WAY VALVE | NORMALLY CLOSED

DHL.H90.1250

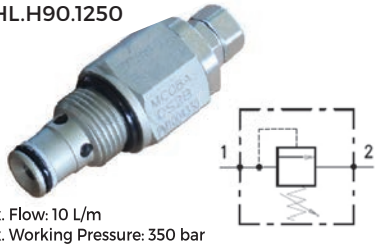

Max. Flow: 10 L/m
Max. Working Pressure: 350 bar

PRESSURE RELIEF VALVE 250 BAR

DHL.H90.1260



SPEED RELIEF VALVE

DHL.H90.1310



Opening Length: 40 cm
Closed: 62 cm Open: 102 cm

LIFTING CYLINDER LONG ARM

DHL.H90.1320



Opening Length: 24 cm
Closed: 90 cm Open: 114 cm

TILT CYLINDER LONG ARM

DHL.H90.1261



SPEED RELIEF VALVE

DHL.H90.1270



VALVE MANIFOLD

DHL.H90.1330



Opening Length: 30 cm
Closed: 52 cm Open: 82 cm

LIFTING CYLINDER SHORT ARM

DHL.H90.1340



Opening Length: 24 cm
Closed: 77 cm Open: 101 cm

TILT CYLINDER SHORT ARM

DHL.H90.1280



CHECK VALVE MANIFOLD

DHL.H90.1290



CHECK VALVE MANIFOLD

DHL.H90.1350



Closed: 36,5 cm Open: 55,8 cm

LIFTING CYLINDER 1.000 kg

DHL.H90.1360



Closed: 47,2 cm Open: 70 cm

TILT CYLINDER 1.000 kg

DHL.H90.1300
Diameter: 20mm
Length: 45mm

DHL.H90.1301
Diameter: 22mm
Length: 25mm

DHL.H90.1302
Diameter: 22mm
Length: 13mm

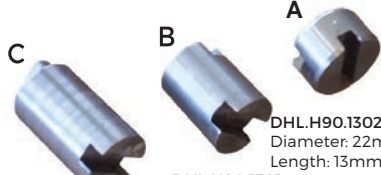

MOTOR COUPLINE

DHL.H90.1370



Opening Length: 19,7 cm
Closed: 34,3 cm Open: 54 cm

LIFTING CYLINDER 750 kg

DHL.H90.1380



Opening Length: 33,3 cm
Closed: 44,1 cm Open: 77,4 cm

TILT CYLINDER 750 kg

DHL.H90.1400 (Short)



PISTON ADJUSTING NUT

DHL.H90.1410 (Long)



PISTON ADJUSTING NUT

DHL.H90.1480



Diameter: 30 mm
Shaft Length: 280 mm

LIFTING SHAFT 750 kg

DHL.H90.1485



Diameter: 30 mm
Shaft Length: 420 mm

TILT SHAFT 750 kg

DHL.H90.1450



Diameter: 60 mm
Shaft Length: 491 mm

LIFTING SHAFT LONG ARM

DHL.H90.1455



Diameter: 60 mm
Shaft Length: 387 mm

LIFTING SHAFT SHORT ARM

DHL.H90.1500



HYDRAULIC HOSE 16 / 1,5 10X30 cm

DHL.H90.1510



HYDRAULIC HOSE 16 / 1,5 10X43 cm

DHL.H90.1460



Diameter: 50 mm
Shaft Length: 387 mm

LIFTING SHAFT 1.000 kg

DHL.H90.1465



Diameter: 50 mm
Shaft Length: 585 mm

TILT SHAFT LONG ARM

DHL.H90.1520



HYDRAULIC HOSE 16 / 1,5 10X75 cm

DHL.H90.1530



HYDRAULIC HOSE 16 / 1,5 10X90 cm

DHL.H90.1470



Diameter: 40 mm
Shaft Length: 585 mm

TILT SHAFT SHORT ARM

DHL.H90.1475



Diameter: 40 mm
Shaft Length: 585 mm

TILT SHAFT 1.000 kg

DHL.H90.1550

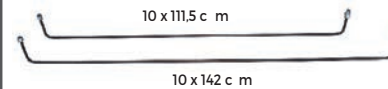

10 x 111,5 c m

10 x 142 c m

LIFTING CYLINDER 750 kg

DHL.H90.1560

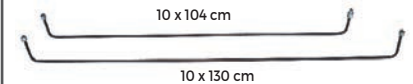

10 x 104 cm

10 x 130 cm

TILT CYLINDER 750 kg



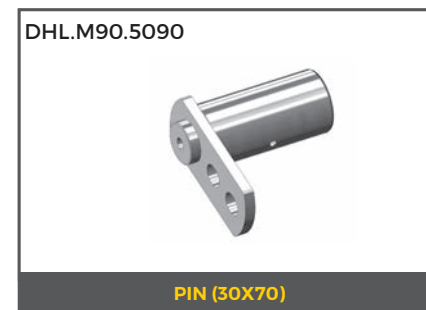
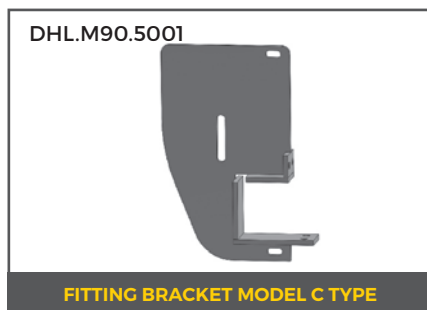
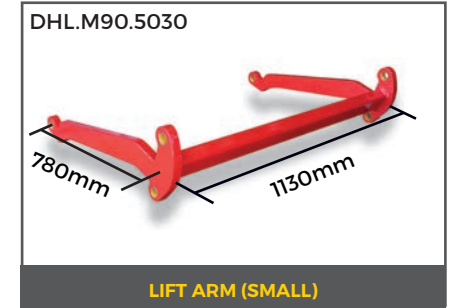
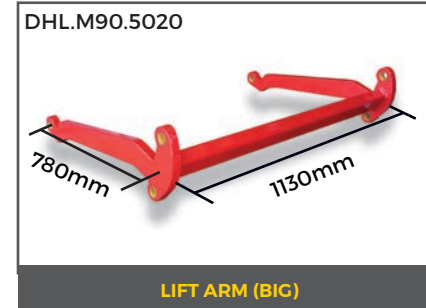

DHL.P90.7000



ALUMINUM PLATFORM

DHL.P90.7010



STEEL PLATFORM

DHL.H90.1590



STEEL PIPE ELEMENTS

DHL.H90.1600



TILT CYLINDER SPRING

DHL.P90.7020

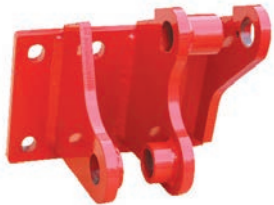

PLATFORM FLUSH (RIGHT)

DHL.P90.7030



PLATFORM FLUSH (LEFT)

DHL.H90.1610



CYLINDER COVER

DHL.H90.1700



POWER UNIT COVER

DHL.P90.7100



RUBBER BUMPER

DHL.P90.7160



FLAG

DHL.H90.1710



LATCH

DHL.H90.1750



OIL TANK (PLASTIC)

DHL.P90.7170



PLATFORM ROLLER

DHL.H90.1760



TANK CAP

DHL.H90.1761



TANK CAP 1/2



CODE	PRODUCT	∅ (mm)	BEARING (mm)	PRESSURE SEAL (mm)	DUST SEAL (mm)
H90-1620	Lifting Cylinder	60	60 x 65 x 20	60 x 70 x 10	60 x 70 x 7,5
H90-1630	Lifting Cylinder	50	50 x 55 x 20	50 x 60 x 10	50 x 60 x 7,5
H90-1640	Lifting Cylinder	25		Kompact 50 x 38 x 20,5	25 x 33 x 5
H90-1650	Tilt Cylinder	40		Kompact 70 x 54 x 20,5	70 x 54 x 20,5
H90-1660	Tilt Cylinder	40		Kompact 70 x 54 x 20,5	40 x 48 x 7,5
H90-1670	Tilt Cylinder	25		Kompact 50 x 38 x 20,5	25 x 33 x 5



Contact Us

www.dahlen.com.tr

sales@dahlen.com.tr

+90 (312) 395 50 62

+90 (312) 395 50 63

Çağdaş Emek Sanayi Sitesi

1438. Cadde No : 19

İvedik - Ankara / TURKEY

DAHL**EN**
EUROPA